

PART NUMBER

KWG177454

REV.

DATE

COMMENTS

INITIAL

Electrical Data

Frequency Range

8.2 ~ 12.5 GHz.

VSWR

1.3 Max

Power Handling

380 W (CW)

RoHS Compliant

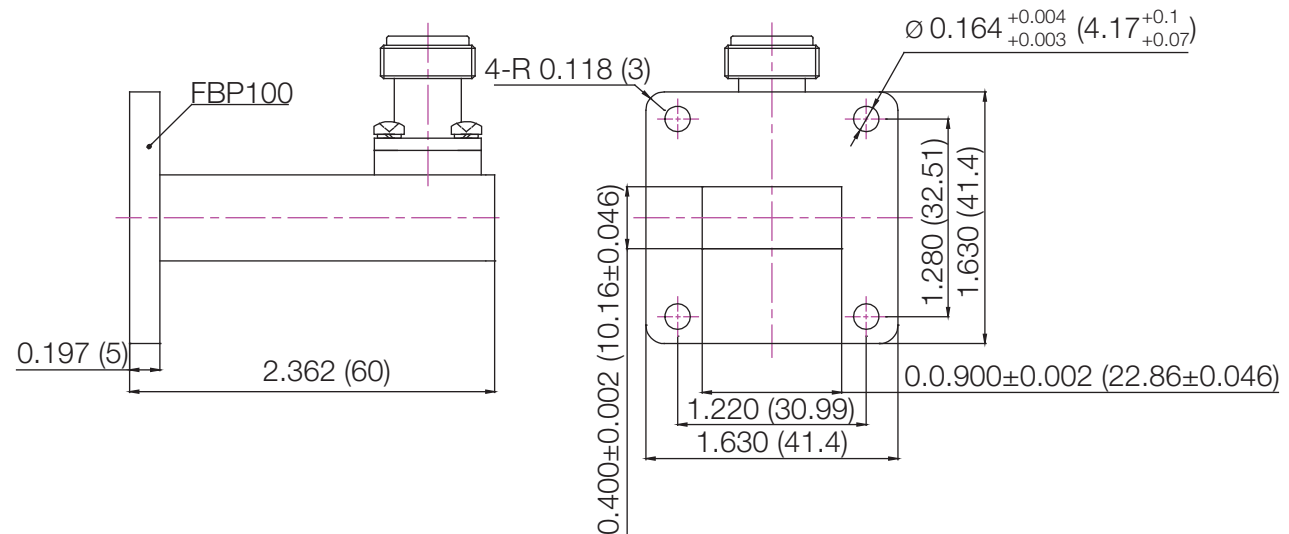
**Drawing not to scale. Dimensions for reference only****Units: inches (mm)****Konnnect RF**

WWW.KONNECTRF.COM
1-800-790-5887

PART NUMBER

KWG177454

DESCRIPTION

Waveguide, Adaptor , TNC Female

CAGE CODE

664U0

SIGNATURE

X

THIS DRAWING INCLUDING THE
 DESIGNS IS THE PROPERTY OF
 KONNECT RF AND IS NOT TO
 BE USED FOR ANY PURPOSE
 WITHOUT OUR APPROVAL.

Component

Body
 Inside Finish
 Outside Finish

Material

Brass

Plating

Copper
 Silver
 Corrosion Protected
 with Grey Paint