

PART NUMBER

KCC178648

REV.

INITIAL

Electrical Data

| | |
|-----------------------|-------------|
| Impedance | 50 Ω |
| Frequency Range | DC - 18 GHz |
| Insulation Resistance | ≥5000 MΩ |
| Center Conductor | ≤3.0 MΩ |
| Outer Conductor | ≤5.0 MΩ |
| IVW | ≥1000 V |
| Durability | ≥500 Cycles |

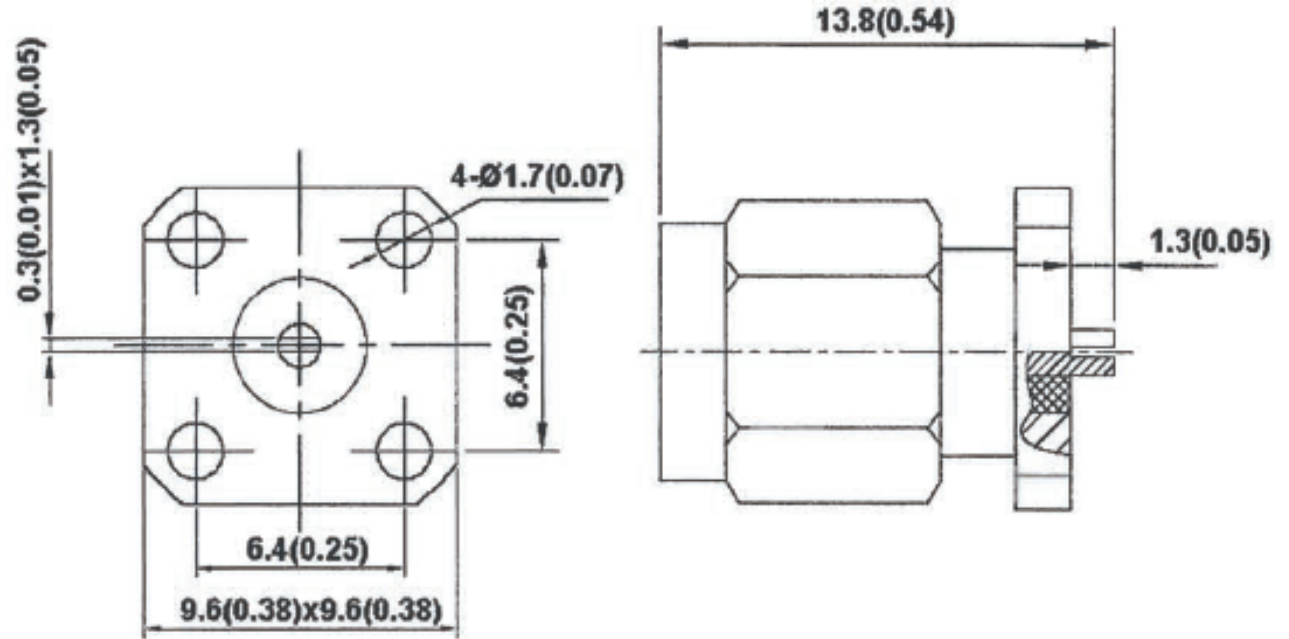
RoHS Compliant

VSWR and Frequency Range Specifications are for reference and are dependant on cable type and other application specific conditions

Drawing not to scale. Dimensions for reference only

WWW.KONNECTRF.COM
1-800-790-5887

PART NUMBER

KCC178648

DESCRIPTION

SMA Straight Male Plug Receptacle - 4 Hole Flange Mount (0.38") - Slot Terminal (0.01")

CAGE CODE

664U0

SIGNATURE

X

Materials

Body
Center Conductor
Insulator

Stainless Steel
Be.Cu
PTFE

Passivated
Gold Plated

THIS DRAWING INCLUDING THE DESIGNS IS THE PROPERTY OF KONNECT RF AND IS NOT TO BE USED FOR ANY PURPOSE WITHOUT OUR APPROVAL.