

PART NUMBER

KAD179291

REV.

DATE

COMMENTS

INITIAL

Electrical Data

Impedance	50 Ω
Frequency Range	DC ~ 18 GHz.
Insertion Loss	0.2dB Max
Voltage Rating	375 VRMS
Contact Resistance	$\leq 3M\Omega$
Insulation Resistance	5000 M Ω Min
VSWR	1.12(-25dB) @ DC~6Ghz Max 1.21(-20dB) @ 6~18GHz Max
Power Handling	2 Watt
RF Leakage	≤ -70 dB
Working Voltage	335 VRMS Max

Mechanical Data

Temperature Range: -55 °C ~ +155 °C

RoHS Compliant

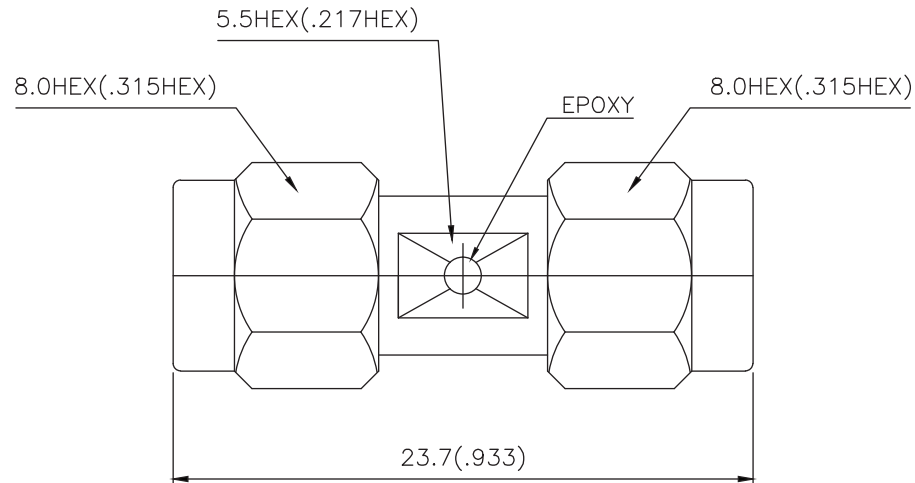

Drawing not to scale. Dimensions for reference only

Units: mm (inches)

Konnect RF

WWW.KONNECTRF.COM
1-800-790-5887

PART NUMBER

KAD179291

DESCRIPTION

Adapter, In Series, SMA Straight Male Plug to SMA Straight Male Plug

CAGE CODE

664U0

SIGNATURE

X

Component

Coupling Cap
Body
Center Contact
Insulator

Material

Brass
Brass
Brass
PTFE

Plating

Gold
Gold
Gold

THIS DRAWING INCLUDING THE DESIGNS IS THE PROPERTY OF KONNECT RF AND IS NOT TO BE USED FOR ANY PURPOSE WITHOUT OUR APPROVAL.