

PART NUMBER

KWG177434

REV.

DATE

COMMENTS

INITIAL

Electrical Data

Frequency Range	12.4 - 18 GHz.
Power	100 wt CW
Press	10 PSI Max
VSWR	1.10 Max

RoHS Compliant

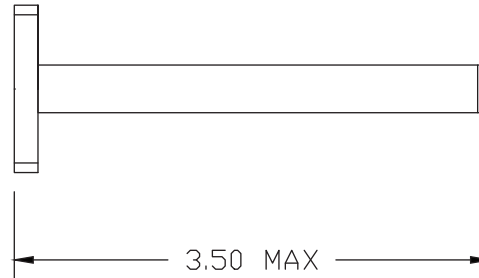

Drawing not to scale. Dimensions for reference only Units: inches



WWW.KONNECTRF.COM
1-800-790-5887

PART NUMBER KWG177434		DESCRIPTION Waveguide, WR62 Termination		
CAGE CODE 664U0	SIGNATURE X 	Component Body	Material Aluminum	Plating/Finish Black
THIS DRAWING INCLUDING THE DESIGNS IS THE PROPERTY OF KONNECT RF AND IS NOT TO BE USED FOR ANY PURPOSE WITHOUT OUR APPROVAL.				