

PART NUMBER

KWG177203

REV.

INITIAL

Electrical Data

Frequency Range	9 - 10 GHz
Isolation	22 dB Min.
Insertion Loss	0.20 dB Max.
VSWR	1.18 Max.
Average Power	200 Watt
Peak Power	500 Watt
Operating Temperature	-30°C to + 70°C

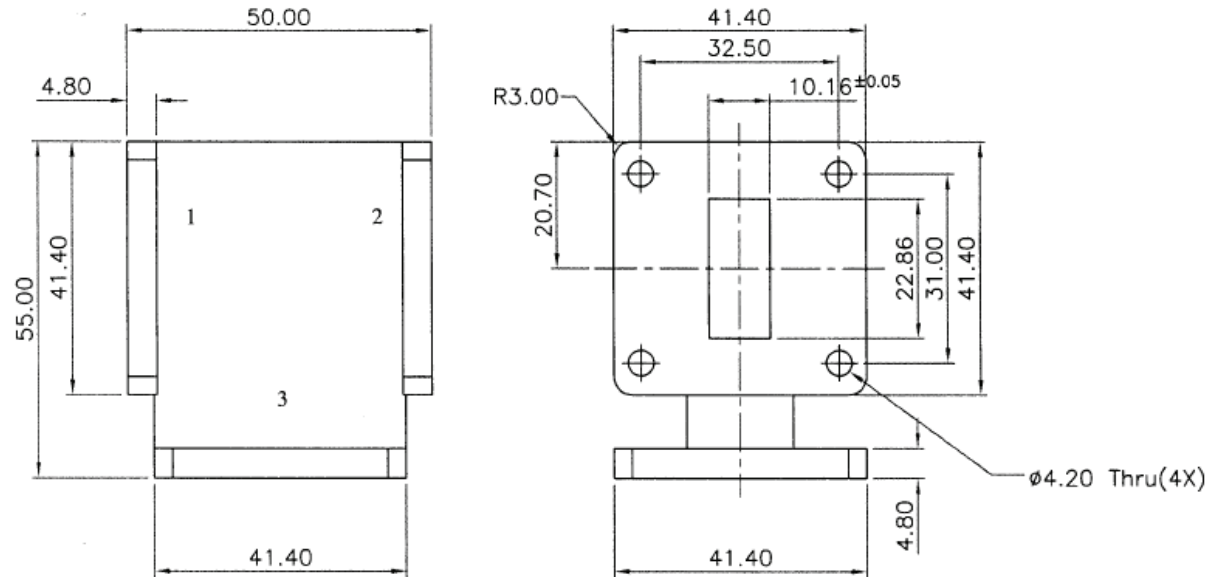
RoHS Compliant

VSWR and Frequency Range Specifications are for reference and are dependant on cable type and other application specific conditions

Drawing not to scale. Dimensions for reference only

Units: mm

Konnect RF

WWW.KONNECTRF.COM
1-800-790-5887

PART NUMBER

KWG177203

DESCRIPTION

Waveguide Circulator, WR90

CAGE CODE

664U0

SIGNATURE

X

THIS DRAWING INCLUDING THE DESIGNS IS THE PROPERTY OF KONNECT RF AND IS NOT TO BE USED FOR ANY PURPOSE WITHOUT OUR APPROVAL.

Component
Body

Material
Aluminum

Plating
Yellow chromate