

End-launch Waveguide to Coaxial Adapter

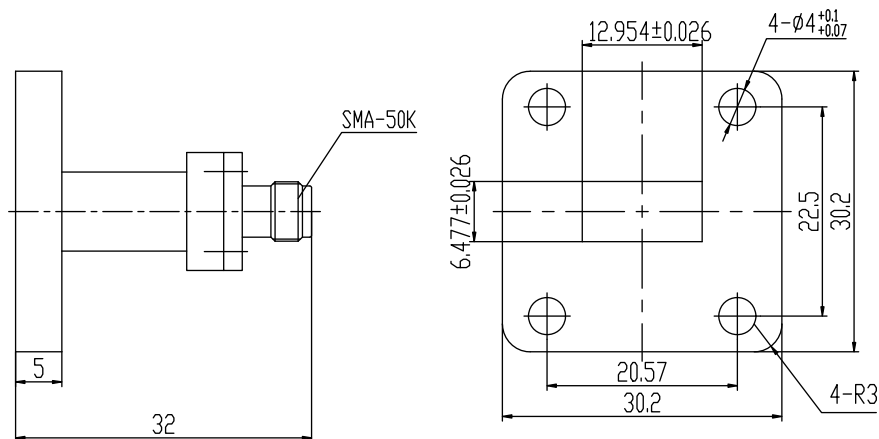

1.0 Mechanical Specifications		
1.1	Waveguide Type	WR51
1.2	Flange Type	Cover
1.3	Connector Type	SMA Female
1.4	Material	Copper
1.5	Inside Finish	Silver Plating
1.6	Outside Finish	Anticorrosion grey paint
2.0 Electrical Specifications		
2.1	Frequency Range	14.5-22.0 GHz
2.2	VSWR (Max)	1.30
2.3	Max. Insertion loss	0.3dB