

PART NUMBER

**KWG177163**

REV.

DATE

COMMENTS

INITIAL

**Electrical Data**

RoHS Compliant

Frequency Range	9.3-9.6 GHz.
Isolation	20 dB
Return Loss	20 dB
Insertion Loss	0.3dB Max
Peak Power	1,000W
Average Power	250W

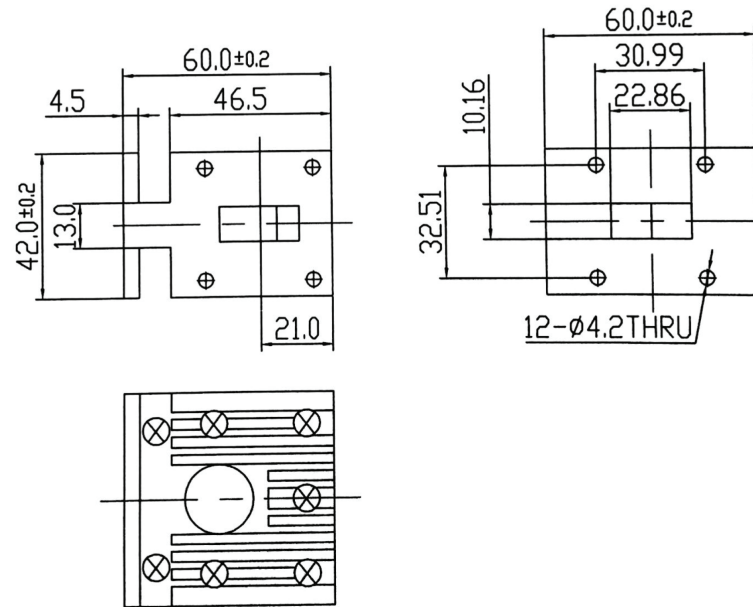

Drawing not to scale. Dimensions for reference only

Units: mm

**Konnect RF**

WWW.KONNECTRF.COM  
1-800-790-5887

PART NUMBER

**KWG177163**

DESCRIPTION

**Waveguide Circulator, WR90**

CAGE CODE

**664U0**

SIGNATURE

X

THIS DRAWING INCLUDING THE  
DESIGNS IS THE PROPERTY OF  
KONNECT RF AND IS NOT TO  
BE USED FOR ANY PURPOSE  
WITHOUT OUR APPROVAL.