

PART NUMBER

KWKG177149

REV.

DATE

COMMENTS

INITIAL

Electrical Data

Impedance	50 Ω
Frequency Range	9.84-15GHz.
Insertion Loss	0.3dB
VSWR	1.25:1
Waveguide type	Rectangular Waveguide WR-75
Flange type	FBP120(Cover)

Mechanical Data

Temperature Range: -40 °C - 70 °C

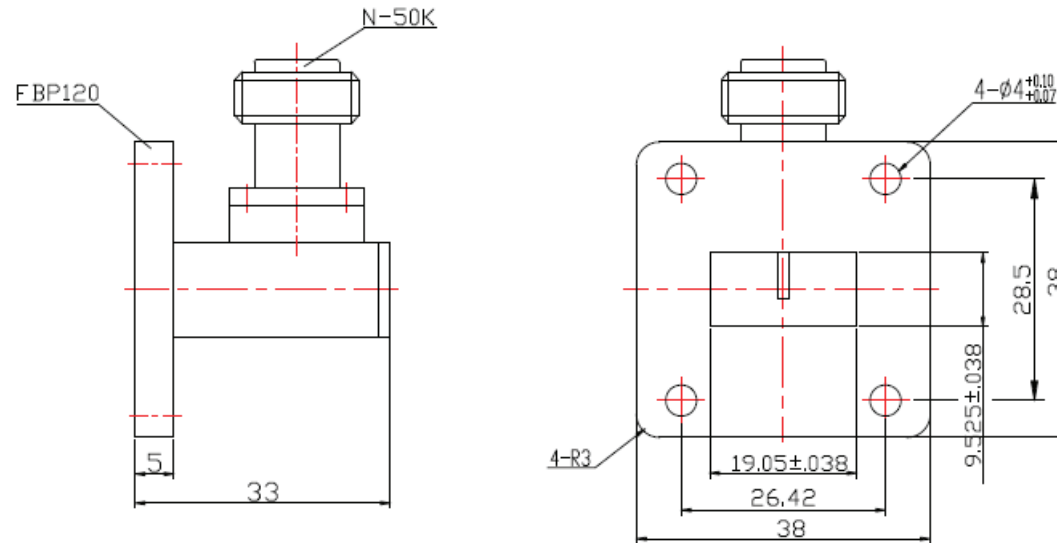
RoHS Compliant

Drawing not to scale. Dimensions for reference only

Units: mm

Konnect RF

WWW.KONNECTRF.COM
1-800-790-5887

PART NUMBER

KWKG177149

DESCRIPTION

Waveguide, WR75, 9.84-15 GHz

CAGE CODE

664U0

SIGNATURE

X

Component
Basis Material
inside Finish
Outside Finish

Material
Copper/Brass

Plating

Silver
Corrosion Protected w/Grey Paint

THIS DRAWING INCLUDING THE
DESIGNS IS THE PROPERTY OF
KONNECT RF AND IS NOT TO
BE USED FOR ANY PURPOSE
WITHOUT OUR APPROVAL.