

PART NUMBER

KWG177134

REV.

DATE

COMMENTS

INITIAL

Electrical Data

Frequency Range 9.3-9.6 GHz.
 Isolation 20 dB
 Insertion Loss 0.3dB Max
 Power Rating 300 W AVG, 6Kw PEAK
 Pressure 30 PSI
 VSWR 1.20 MAX

Mechanical Data

Temperature Range: -10 °C - 65 °C

RoHS Compliant

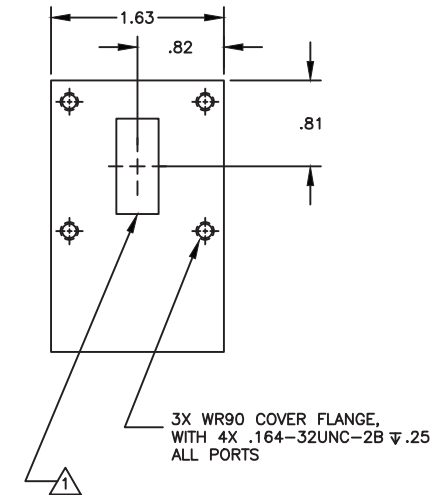
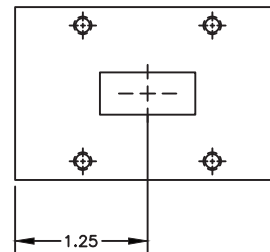
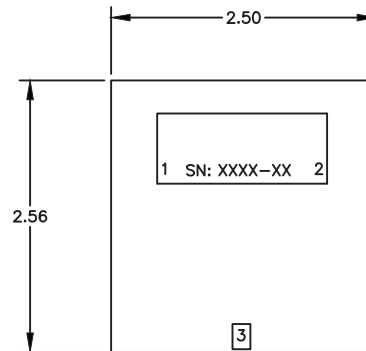

3. UNIT MUST BE MOUNTED TO PROPER HEATSINK TO MAINTAIN CASE TEMP.

2. MARK PORTS AS SHOWN.

1 MATES WITH UG135/U FLANGE, ALL THREE PORTS.

NOTES:

Drawing not to scale. Dimensions for reference only

Units: inches

WWW.KONNECTRF.COM
 1-800-790-5887

PART NUMBER

KWG177134

DESCRIPTION

Waveguide Circulator, WR90

CAGE CODE

664U0

SIGNATURE

X

THIS DRAWING INCLUDING THE
 DESIGNS IS THE PROPERTY OF
 KONNECT RF AND IS NOT TO
 BE USED FOR ANY PURPOSE
 WITHOUT OUR APPROVAL.