

PART NUMBER

**KWG177123**

REV.

DATE

COMMENTS

INITIAL

**Electrical Data**

Frequency Range	37.5-42.5 GHz
Insertion Loss	0.5 dB
Isolation	17 dB min
VSWR	1.4 Max

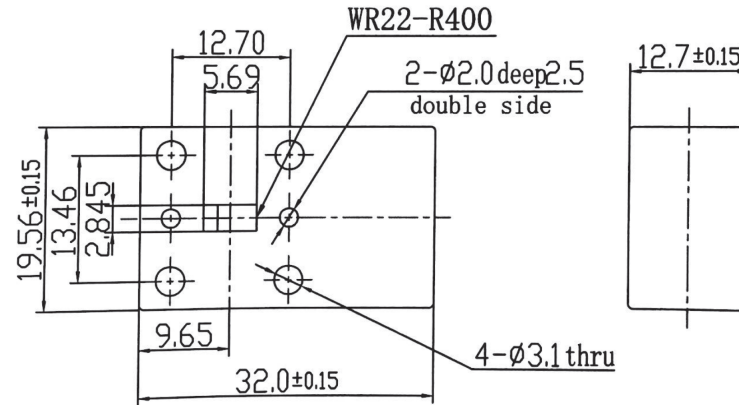
**RoHS Compliant**

Drawing not to scale. Dimensions for reference only

Units: mm

**Konnect RF**

WWW.KONNECTRF.COM  
1-800-790-5887

PART NUMBER

**KWG177123**

DESCRIPTION

**Waveguide, Isolator, WR22**

CAGE CODE

**664U0**

SIGNATURE

X

THIS DRAWING INCLUDING THE  
DESIGNS IS THE PROPERTY OF  
KONNECT RF AND IS NOT TO  
BE USED FOR ANY PURPOSE  
WITHOUT OUR APPROVAL.