

PART NUMBER

**KWG177121**

REV.

DATE

COMMENTS

INITIAL

**Electrical Data**

Frequency Range 4.40 - 5.00 GHz.  
 VSWR  $\leq 1.15$

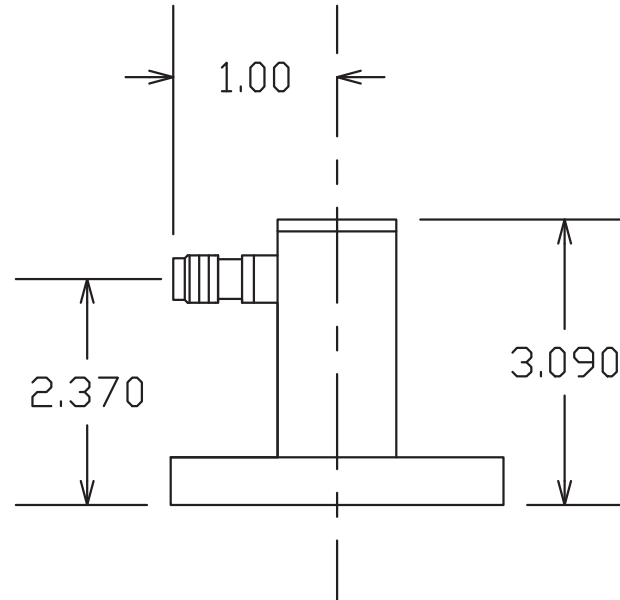
**RoHS Compliant**

Drawing not to scale. Dimensions for reference only

Units: inches

**Konnect RF**

WWW.KONNECTRF.COM  
 1-800-790-5887

PART NUMBER

**KWG177121**

DESCRIPTION

**Waveguide to Coaxial Adapter, WR187 to 90 Degree  
 Type SMA Female Jack, Cover Flange**

CAGE CODE

**664U0**

SIGNATURE

X

**Component**  
 Body

**Material**

WR 187 OFHC

**Plating/Finish**

CB-30 Flat Black Epoxy

THIS DRAWING INCLUDING THE  
 DESIGNS IS THE PROPERTY OF  
 KONNECT RF AND IS NOT TO  
 BE USED FOR ANY PURPOSE  
 WITHOUT OUR APPROVAL.