

PART NUMBER

KWG177109

REV.

DATE

COMMENTS

INITIAL

RoHS Compliant**Electrical Data**

Frequency Range	3.95 - 5.85 GHz.
Insertion Loss	0.04
Pressure	10 PSI
VSWR	1.05

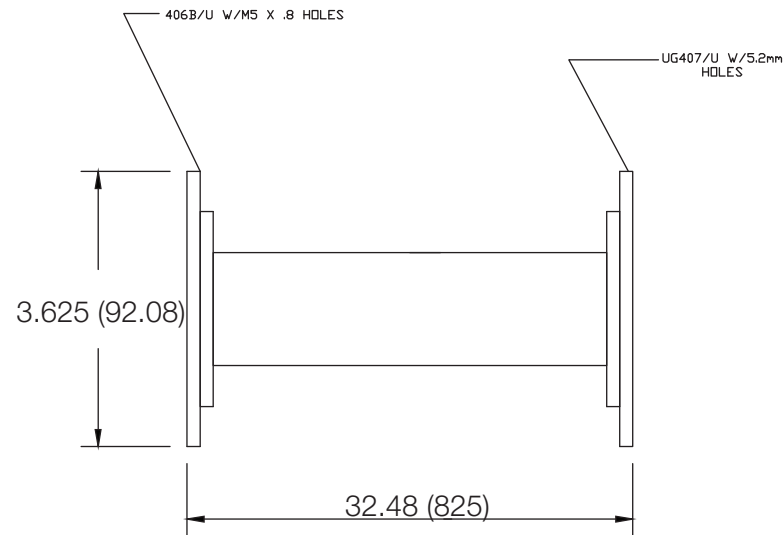

Drawing not to scale. Dimensions for reference only

Units: mm

Konnect RF

WWW.KONNECTRF.COM
1-800-790-5887

PART NUMBER

KWG177109

DESCRIPTION

Straight Wave Guide WR187, UG407/U Flange to UG406B/U

CAGE CODE

664U0

SIGNATURE

X

Component
Body

Material
Alum 6061-T6

Plating/Finish
Metalast TCP-HF
Epoxy Flat Black

THIS DRAWING INCLUDING THE
DESIGNS IS THE PROPERTY OF
KONNECT RF AND IS NOT TO
BE USED FOR ANY PURPOSE
WITHOUT OUR APPROVAL.