

PART NUMBER

**KWG177107**

REV.

DATE

COMMENTS

INITIAL

**Electrical Data**

Frequency Range	3.95 - 5.85 GHz.
Insertion Loss	0.04
Pressure	10 PSI
VSWR	1.05

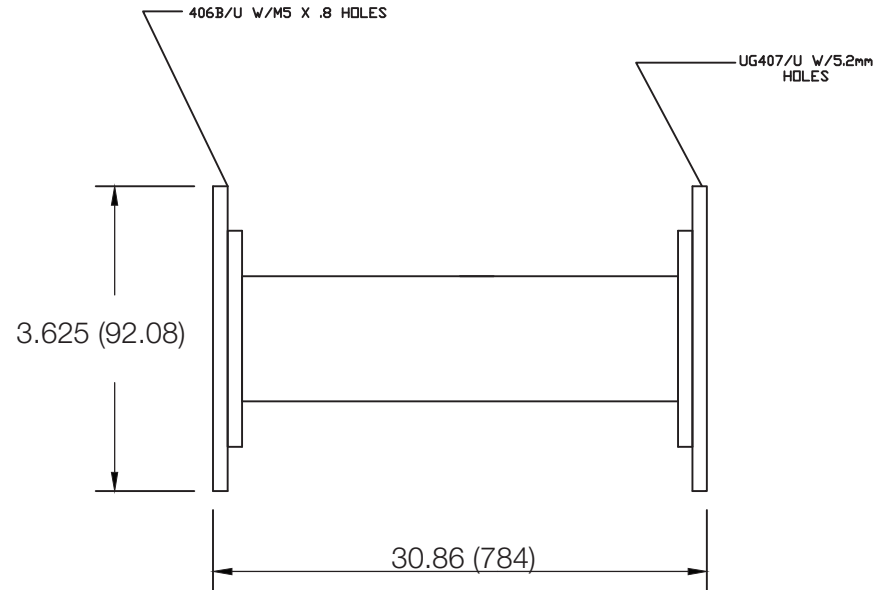
**RoHS Compliant**

Drawing not to scale. Dimensions for reference only

Units: inches (mm)

**Konnect RF**

WWW.KONNECTRF.COM  
1-800-790-5887

PART NUMBER

**KWG177107**

DESCRIPTION

**Straight Wave Guide WR187, UG407/U Flange to UG406B/U**

CAGE CODE

**664U0**

SIGNATURE

X

**Component**  
Body

**Material**  
Alum 6061-T6

**Plating/Finish**  
Metalast TCP-HF  
Epoxy Flat Black

THIS DRAWING INCLUDING THE  
DESIGNS IS THE PROPERTY OF  
KONNECT RF AND IS NOT TO  
BE USED FOR ANY PURPOSE  
WITHOUT OUR APPROVAL.