

PART NUMBER

KPD177554

REV.

DATE

COMMENTS

INITIAL

Electrical Data

Impedance	50 Ω
Frequency Range	1 - 40 GHz.
Insertion Loss	2.4 dB Max
Isolation	18 dB Min
Amplitude Balance	+/- 0.5 dB Max
Phase Balance	5 Degrees
Forward Power	20 Watts
VSWR	1.60 Max

Mechanical Data

Temperature Range: -35 °C - 85 °C

RoHS Compliant

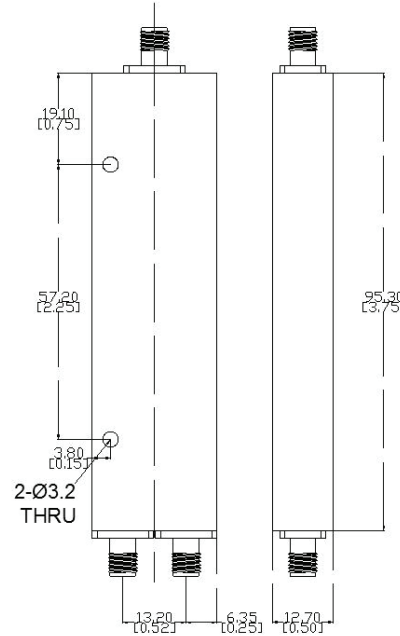

Drawing not to scale. Dimensions for reference only

Units: mm (inches)

Konnect RFWWW.KONNECTRF.COM
1-800-790-5887

PART NUMBER

KPD177554

DESCRIPTION

Power Divider, 2 Way, 2.92 Female Jack

CAGE CODE

664U0

SIGNATURE

X

THIS DRAWING INCLUDING THE DESIGNS IS THE PROPERTY OF KONNECT RF AND IS NOT TO BE USED FOR ANY PURPOSE WITHOUT OUR APPROVAL.