

PART NUMBER

**KIS177346**

REV.

INITIAL

**Electrical Data**

Frequency Range	3.90 - 4.40 GHz
VSWR	1.33 Max.
Insertion Loss	0.60 dB Max.
Isolation	15 dB Min.
Average Power	20 Watt
Peak Power	50 Watt
Operating Temperature	-30° to + 70°C

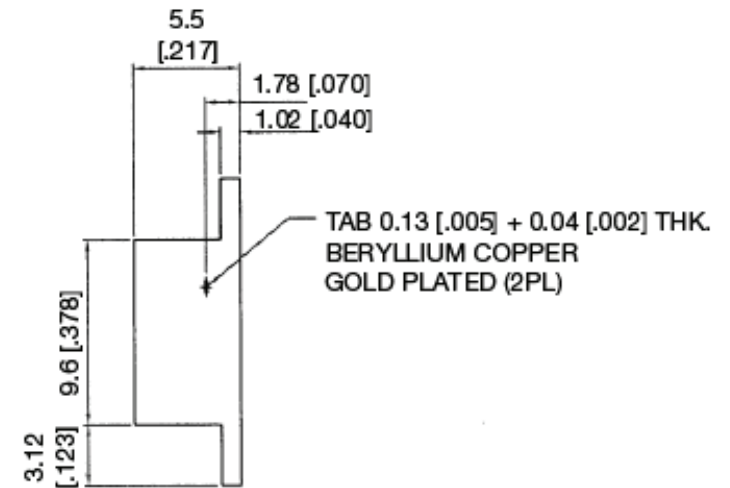
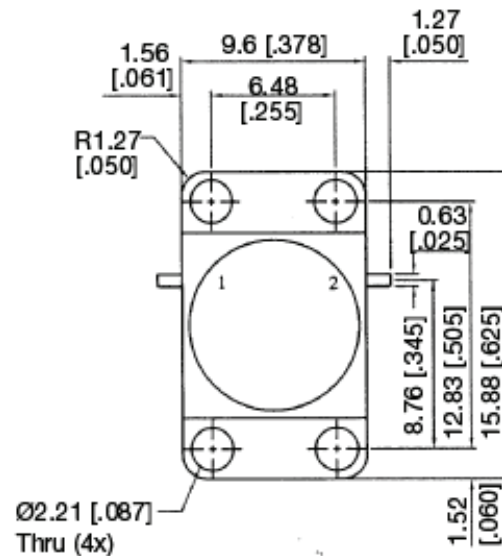
**RoHS Compliant**

VSWR and Frequency Range Specifications  
are for reference and are dependant on cable  
type and other application specific conditions

Drawing not to scale. Dimensions for reference only

WWW.KONNECTRF.COM  
540 NW University Blvd. Ste. 109  
Port Saint Lucie, Florida, 34986  
1-800-790-5887

PART NUMBER

**KIS177346**DESCRIPTION **Isolator - Drop In - Flange Mount**

CAGE CODE

**664U0**

SIGNATURE

X

THIS DRAWING INCLUDING THE  
DESIGNS IS THE PROPERTY OF  
KONNECT RF AND IS NOT TO  
BE USED FOR ANY PURPOSE  
WITHOUT OUR APPROVAL.