

PART NUMBER

**KIS177211**

REV.

DATE

COMMENTS

INITIAL

**Electrical Data**

Impedance	50 $\Omega$
Frequency Range	2.2-3.5 GHz.
Insertion Loss	$\leq 0.5$ dB
Reverse Isolation	$\geq 15$ dB
Power Rating	10W
Reverse Power	10 W
VSWR	$\leq 1.30$

**RoHS Compliant****Mechanical Data**

Temperature Range: -10 °C - 60 °C

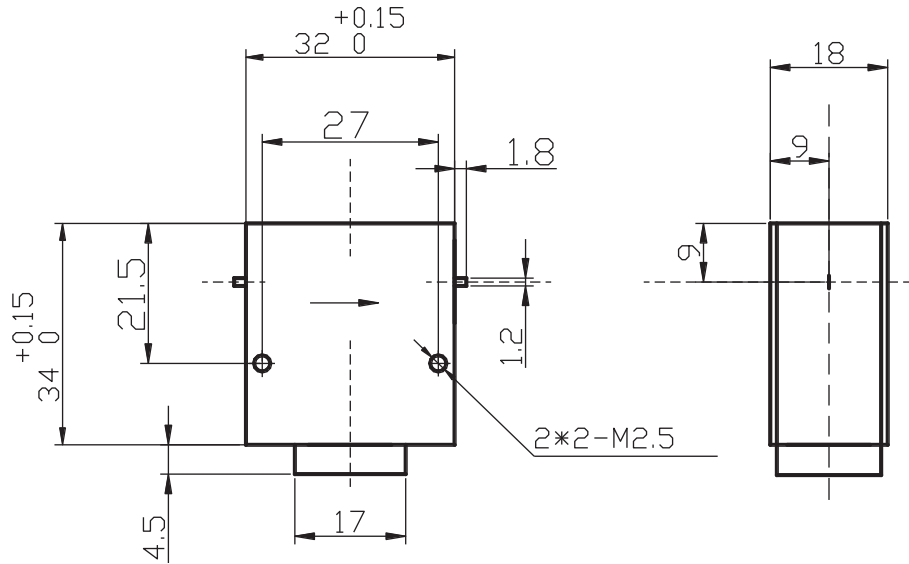

Drawing not to scale. Dimensions for reference only

Units: (mm)

**Konnect RF**

WWW.KONNECTRF.COM  
1-800-790-5887

PART NUMBER

**KIS177211**

DESCRIPTION

**Isolator, Stripline**

CAGE CODE

**664U0**

SIGNATURE

X

THIS DRAWING INCLUDING THE  
DESIGNS IS THE PROPERTY OF  
KONNECT RF AND IS NOT TO  
BE USED FOR ANY PURPOSE  
WITHOUT OUR APPROVAL.