

PART NUMBER

KIS177197

REV.

DATE

COMMENTS

INITIAL

Electrical Data

| | |
|-----------------|-------------|
| Impedance | 50 Ω |
| Frequency Range | 29-31 GHz. |
| Insertion Loss | 1.0 dB |
| Isolation | 20 dB |
| VSWR | 1.25 Max |

RoHS Compliant

Mechanical Data

Temperature Range: -20 °C - 65 °C

| | |
|------------------------------|---------------|
| Room Temp : | +25 \pm 5°C |
| Isolation dB (Min.) : | 22 |
| Insertion Loss dB (Max.) : | 0.90 |
| VSWR (Max.) : | 1.20 |

Forward Power : 5 W

Reverse Power : 2 W

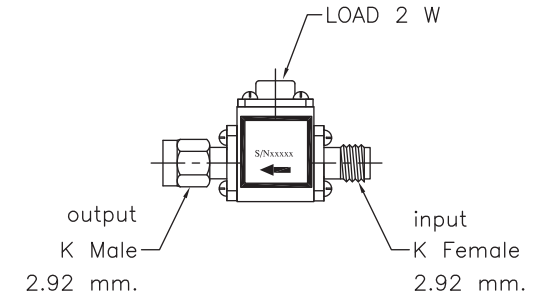
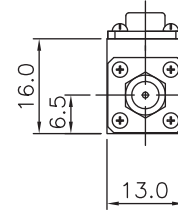
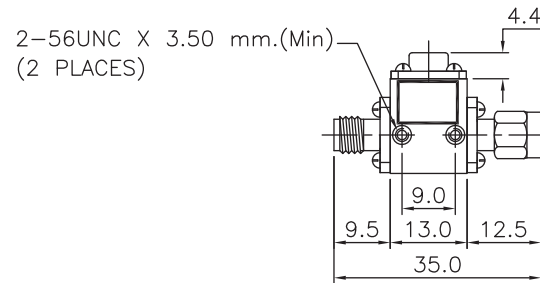

Drawing not to scale. Dimensions for reference only

Units: inches mm

Konnect RF

WWW.KONNECTRF.COM

1-800-790-5887

PART NUMBER

KIS177197

DESCRIPTION

Isolator, 2.92 Female Jack Input, SMA Male Plug Output

CAGE CODE

664U0

SIGNATURE

X

Component
BodyMaterial
AluminumPlating
Nickel

THIS DRAWING INCLUDING THE DESIGNS IS THE PROPERTY OF KONNECT RF AND IS NOT TO BE USED FOR ANY PURPOSE WITHOUT OUR APPROVAL.