

PART NUMBER

**KIS177031**

REV.

DATE

COMMENTS

INITIAL

**Electrical Data**

Impedance	50 $\Omega$
Frequency Range	2.8-3.2 GHz.
Isolation	20 dB
Insertion Loss	0.50 dB
Average Power	1 Watt
VSWR	$\leq 1.25$

RoHS Compliant

**Mechanical Data**

Temperature Range: -50 °C - 85 °C

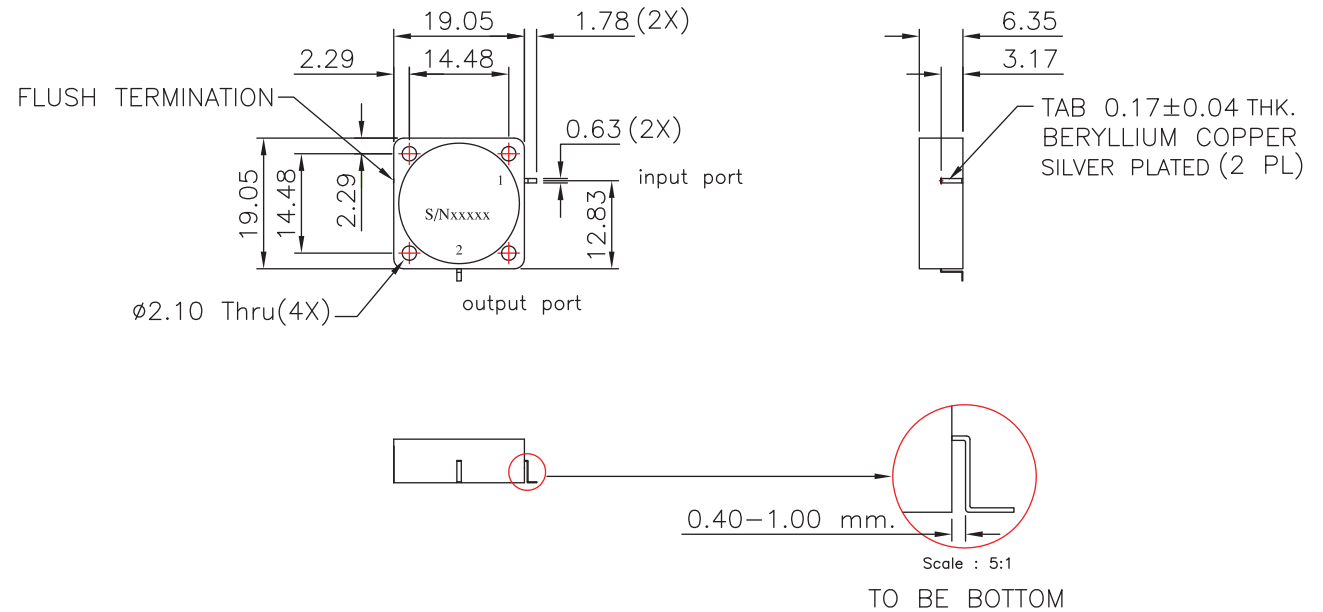

Drawing not to scale. Dimensions for reference only

Units: mm

**Konnect RF**

WWW.KONNECTRF.COM  
1-800-790-5887

PART NUMBER

**KIS177031**

DESCRIPTION

**Isolator, Surface Mount**

CAGE CODE

**664U0**

SIGNATURE

X

THIS DRAWING INCLUDING THE  
DESIGNS IS THE PROPERTY OF  
KONNECT RF AND IS NOT TO  
BE USED FOR ANY PURPOSE  
WITHOUT OUR APPROVAL.