

PART NUMBER

**KIMP177420**

REV.

INITIAL

**Electrical Data**

Impedance	50 $\Omega$ Nominal (Male Side) 75 $\Omega$ Nominal (Female Side)
Frequency Range	DC - 3 GHz
Insertion Loss	5.7 dB Nominal
VSWR	1.4:1 Max.
Input Power	1 Watt

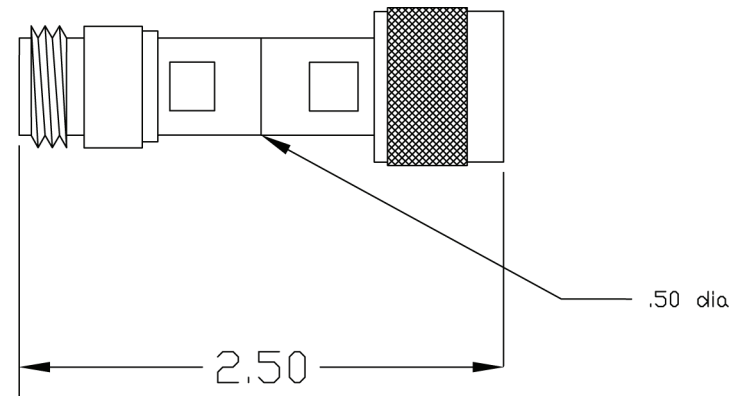

VSWR and Frequency Range Specifications  
are for reference and are dependant on cable  
type and other application specific conditions

Drawing not to scale. Dimensions for reference only

# **Konnnect RF**

540 NW University Blvd. Ste. 109  
Port Saint Lucie, Florida, 34986  
1-800-790-5887

PART NUMBER

**KIMP177420**

DESCRIPTION

**Impedance Matching Pad - N Male Plug 50 Ohms  
to N Female Jack 75 Ohms**

CAGE CODE

**664U0**

SIGNATURE

X 

THIS DRAWING INCLUDING THE  
DESIGNS IS THE PROPERTY OF  
KONNECT RF AND IS NOT TO  
BE USED FOR ANY PURPOSE  
WITHOUT OUR APPROVAL.