

PART NUMBER

KCI177219

REV.

DATE

COMMENTS

INITIAL

Electrical Data

Impedance	50 Ω
Isolation	19dB Min
Average Power	25 Watt
Frequency Range	DC - XX GHz.
Insertion Loss	0.60dB
VSWR	1.25 Max

Mechanical Data

Operating Temperature Range: -54 °C - 84 °C

Room Temp :	+25 \pm 5°C
Isolation dB (Min.) :	22
Insertion Loss dB (Max.) :	0.50
VSWR (Max.) :	1.18

Peak Power : 250 W

Note: Date Code Example : Week 25 in 2010 We Would Read 25/10

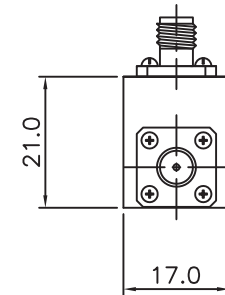
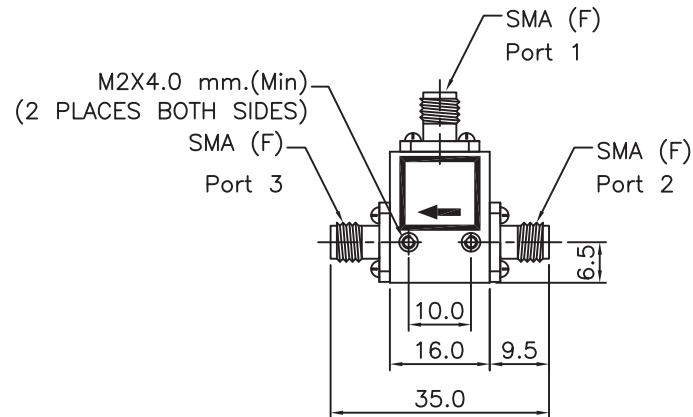
RoHS Compliant

Drawing not to scale. Dimensions for reference only

Units: mm

Konnect RFWWW.KONNECTRF.COM
1-800-790-5887

PART NUMBER

KCI177219

DESCRIPTION

Circulator, SMA Female

CAGE CODE

664U0

SIGNATURE

X

Component
Body**Material**
Aluminum**Plating**
Black PaintTHIS DRAWING INCLUDING THE
DESIGNS IS THE PROPERTY OF
KONNECT RF AND IS NOT TO
BE USED FOR ANY PURPOSE
WITHOUT OUR APPROVAL.