

PART NUMBER

KCC198206

REV.

DATE

COMMENTS

INITIAL

RoHS Compliant

Electrical Data

Impedance	50 Ω
Frequency Range	DC - 40 GHz
Insulation Resistance	$\geq 5,000$ M Ω
Dielectric Withstanding Voltage	500 V
VSWR	≤ 1.30

Mechanical Data

Durability	500 Cycles Min
Temperature Range	-55°C - 165 °C

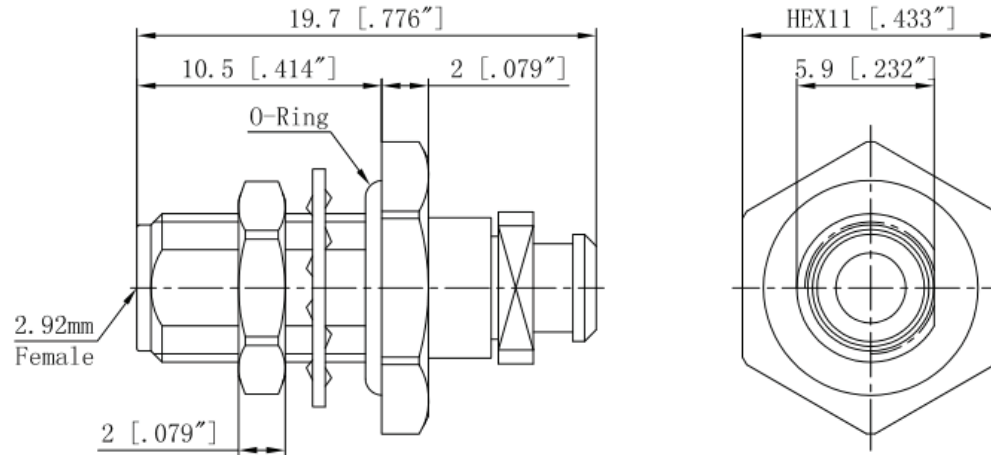

VSWR and Frequency Range Specifications are for reference and are dependant on cable type and other application specific conditions

Drawing not to scale. Dimensions for reference only

Units: mm (inches)

WWW.KONNECTRF.COM
1-800-790-5887

PART NUMBER

KCC198206

DESCRIPTION

**2.92mm Straight Female Jack,
Bulkhead rear mount, Clamp/Solder**

CAGE CODE

664U0

SIGNATURE

X

Cable Types: .085 S/R (RG-405)

Component
Body
Center Contact
Insulator

Material
Stainless Steel
BeCu
PEI

Plating
Passivated
Gold

THIS DRAWING INCLUDING THE DESIGNS IS THE PROPERTY OF KONNECT RF AND IS NOT TO BE USED FOR ANY PURPOSE WITHOUT OUR APPROVAL.