

PART NUMBER

KCC198116

REV.

DATE

COMMENTS

INITIAL

Electrical Data

Impedance 50 Ω
 Frequency Range DC - 12.4 GHz
 Insulation Resistance $\geq 5,000 \text{ M}\Omega\text{Min.}$
 VSWR $\leq 1.35 \text{ Max}$

Mechanical Data

Temperature Range -55 $^{\circ}\text{C}$ - 155 $^{\circ}\text{C}$

RoHS Compliant

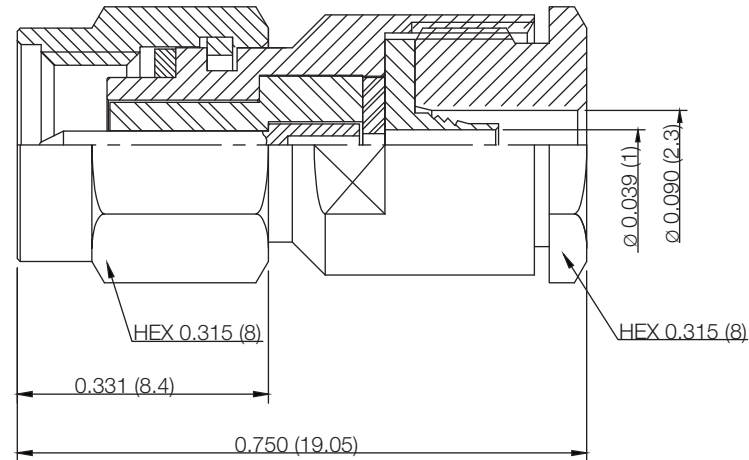

VSWR and Frequency Range Specifications are for reference and are dependant on cable type and other application specific conditions

Drawing not to scale. Dimensions for reference only Units: inches (mm)

WWW.KONNECTRF.COM
1-800-790-5887

PART NUMBER

KCC198116

DESCRIPTION

SMA Straight Male Plug, Clamp

CAGE CODE

664U0

SIGNATURE

X

Cable Types: RG-178**Component****Material****Plating**

Body, Coupling Nut & Cap

Brass

Gold

Center Contact

Brass

Gold

Insulator

PTFE

Gasket

Silicone Rubber

THIS DRAWING INCLUDING THE DESIGNS IS THE PROPERTY OF KONNECT RF AND IS NOT TO BE USED FOR ANY PURPOSE WITHOUT OUR APPROVAL.