

PART NUMBER

KCC197786

REV.

DATE

COMMENTS

INITIAL

Electrical Data

Impedance 50 Ω
 Frequency Range DC - 18 GHz.
 Voltage Rating 500 VRMS
 Dielectric Withstanding Voltage 1500 VRMS

RoHS Compliant

Mechanical Data

Durability 500 Cycles Min.
 Contact Retention 6lbs Axial
 Temperature Range: -40 °C - 165 °C

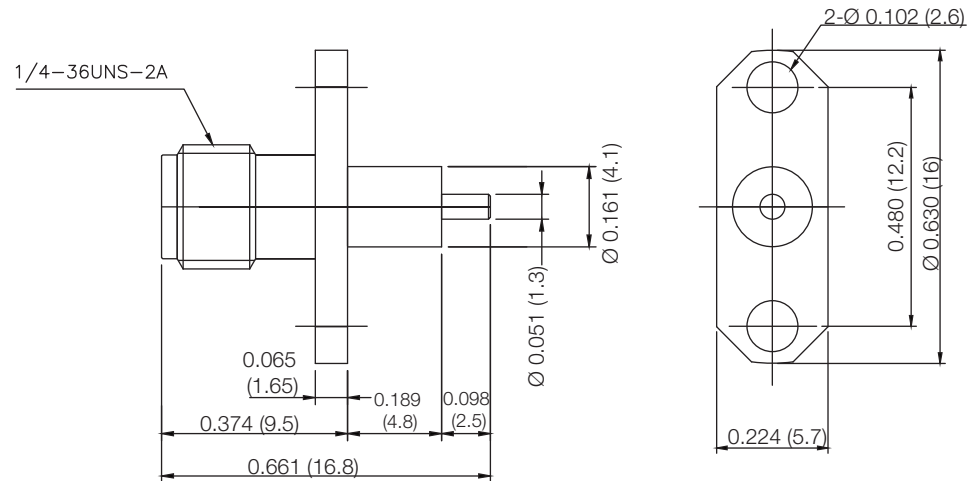

Drawing not to scale. Dimensions for reference only

Units: inches (mm)

Konnnect RF

WWW.KONNECTRF.COM
 1-800-790-5887

PART NUMBER

KCC197786

DESCRIPTION

**SMA Straight Female Jack Receptacle,
2 Hole Flange Mount (0.224\"/>**

CAGE CODE

664U0

SIGNATURE

X

THIS DRAWING INCLUDING THE
 DESIGNS IS THE PROPERTY OF
 KONNECT RF AND IS NOT TO
 BE USED FOR ANY PURPOSE
 WITHOUT OUR APPROVAL.

Component

Body
 Center Contact
 Insulator

Material

Brass
 BeCu
 PTFE

Plating

Nickel
 Gold