

PART NUMBER

KCC197773

REV.

DATE

COMMENTS

INITIAL

Electrical Data

Impedance 50 Ω
 Frequency Range DC - 6GHz.
 Insulation Resistance 5,000M Ω Min
 Dielectric Withstanding Voltage 1.000V
 VSWR \leq 1.30

Mechanical Data

Durability 500 Cycles Min.
 Temperature Range: -55 $^{\circ}$ C - 165 $^{\circ}$ C

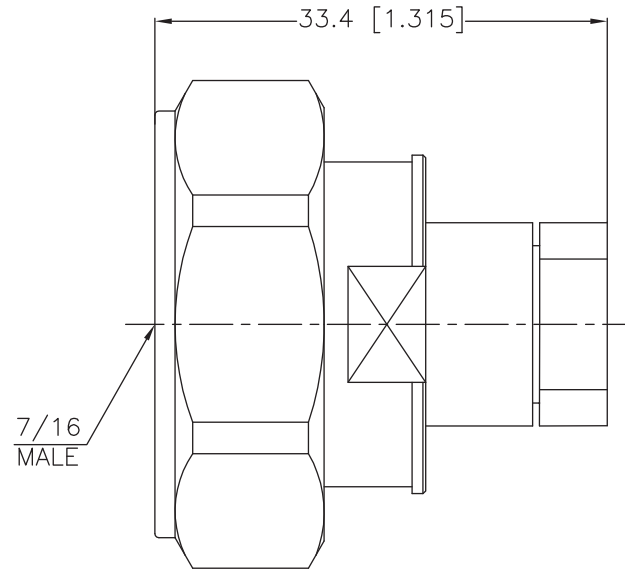
RoHS Compliant

VSWR and Frequency Range Specifications are for reference and are dependant on cable type and other application specific conditions

Drawing not to scale. Dimensions for reference only

Units: mm (Inches)

Konnect RF

WWW.KONNECTRF.COM
 1-800-790-5887

PART NUMBER

KCC197773

DESCRIPTION

7/16 DIN Straight Male Plug

CAGE CODE

664U0

SIGNATURE

X

Cable Types: KRC177206

Component
 Body & Nut
 Center Contact
 Insulator

Material
 Brass
 Brass
 PTFE

Plating
 White Bronze
 Gold

THIS DRAWING INCLUDING THE DESIGNS IS THE PROPERTY OF KONNECT RF AND IS NOT TO BE USED FOR ANY PURPOSE WITHOUT OUR APPROVAL.