

PART NUMBER

KCC197443

REV.

DATE

COMMENTS

INITIAL

Electrical Data

Impedance 50 Ω
 Frequency Range DC - 4.0GHz.
 VSWR 1.20 max @ 3GHz

Mechanical Data

Temperature Range: -45 °C - 145 °C
 Durability 500 Cycles

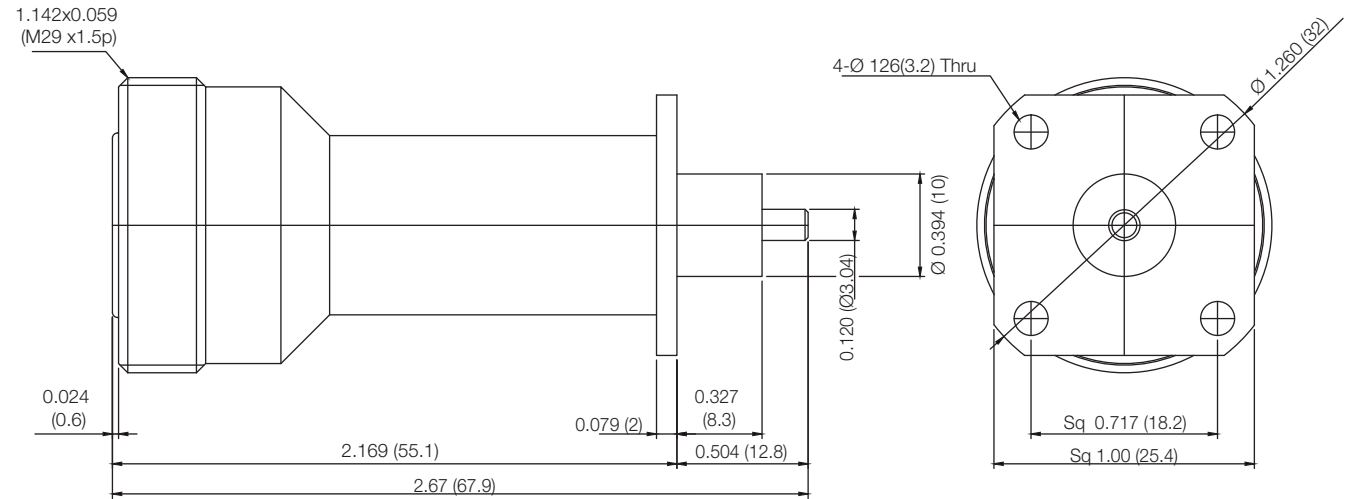
RoHS Compliant

Drawing not to scale. Dimensions for reference only

Units: inches (mm)

Konnnect RF

WWW.KONNECTRF.COM
 1-800-790-5887

PART NUMBER

KCC197443

DESCRIPTION

7/16 DIN F, Female Jack Receptacle, 4 Hole Flange Mount

CAGE CODE

664U0

SIGNATURE

X

THIS DRAWING INCLUDING THE
 DESIGNS IS THE PROPERTY OF
 KONNECT RF AND IS NOT TO
 BE USED FOR ANY PURPOSE
 WITHOUT OUR APPROVAL.

Component

Body
 Center Contact
 Insulator

Material

Brass
 PBrC
 PTFE

Plating

Silver
 Gold