

PART NUMBER

KCC197331

REV.

DATE

COMMENTS

INITIAL

Electrical Data

Impedance 50 Ω
 Frequency Range DC - 18 GHz.
 Insertion Loss 0.05 $\sqrt{\text{Frequency}}$
 Insulation Resistance 5,000 M Ω min
 Dielectric Withstanding Voltage 1,000 Max At sea level
 VSWR ≤ 1.30

Mechanical Data

Temperature Range: -55 $^{\circ}\text{C}$ - 165 $^{\circ}\text{C}$

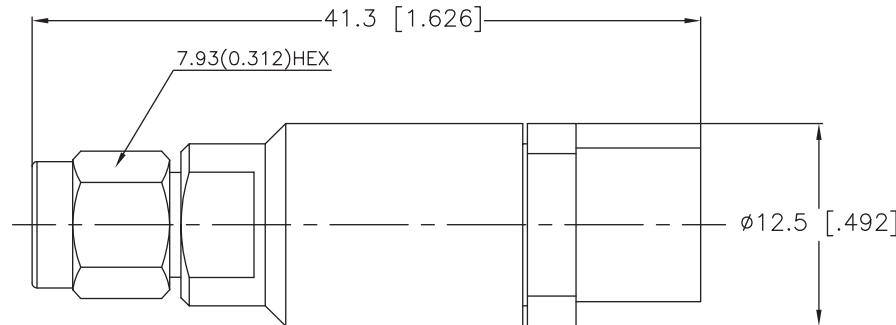
RoHS Compliant

VSWR and Frequency Range Specifications are for reference and are dependant on cable type and other application specific conditions

Drawing not to scale. Dimensions for reference only

Units: mm (Inches)

WWW.KONNECTRF.COM
1-800-790-5887

PART NUMBER

KCC197331

DESCRIPTION

SMA Straight Male Plug, Clamp

CAGE CODE

664U0

SIGNATURE

X

Cable Types: KRC188582**Component**

Body & Nut
Center Contact
Insulator

Material

Stainless Steel
Brass
PTFE

Plating/Finish

Passivated
Gold

THIS DRAWING INCLUDING THE DESIGNS IS THE PROPERTY OF KONNECT RF AND IS NOT TO BE USED FOR ANY PURPOSE WITHOUT OUR APPROVAL.