

PART NUMBER

**KCC197311**

REV.

DATE

COMMENTS

INITIAL

**Electrical Data**

Impedance	50 $\Omega$
Frequency Range	DC-18 GHz
Voltage Rating	500 VRMS
Dielectric Withstanding Voltage	1,500 VRMS
Durability	500 Cycles
Contact Retention	6Lbs Axial

**RoHS Compliant****Mechanical Data**

Temperature Range: -40 °C - 165 °C

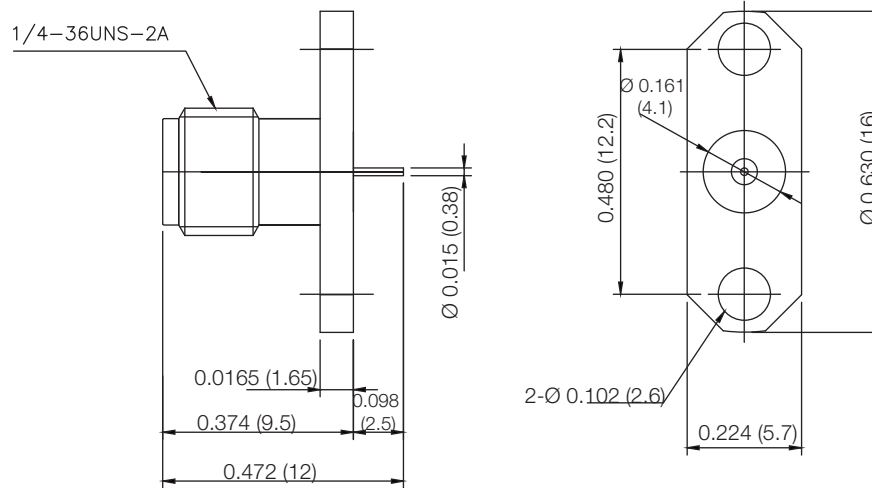

Drawing not to scale. Dimensions for reference only

Units: Inches (mm)

**Konnect RF**

WWW.KONNECTRF.COM  
1-800-790-5887

PART NUMBER

**KCC197311**

DESCRIPTION

**SMA Straight Female Jack Receptacle, 2 Hole Flange Mount**

CAGE CODE

**664U0**

SIGNATURE

X

THIS DRAWING INCLUDING THE  
DESIGNS IS THE PROPERTY OF  
KONNECT RF AND IS NOT TO  
BE USED FOR ANY PURPOSE  
WITHOUT OUR APPROVAL.

**Component**

Body  
Center Contact  
Insulator

**Material**

Stainless Steel  
BeCu  
PTFE

**Plating/Finish**

Passivated  
Gold