

PART NUMBER

KCC197204

REV.

DATE

COMMENTS

INITIAL

Electrical Data

Impedance 50 Ω
 Frequency Range DC - 1GHz.
 Voltage Rating 250VRMS
 Dielectric Withstanding Voltage 750 VRMS
 VSWR 1.30 @ 1GHz Max

Mechanical Data

Operating Temperature: -40 °C - 155 °C

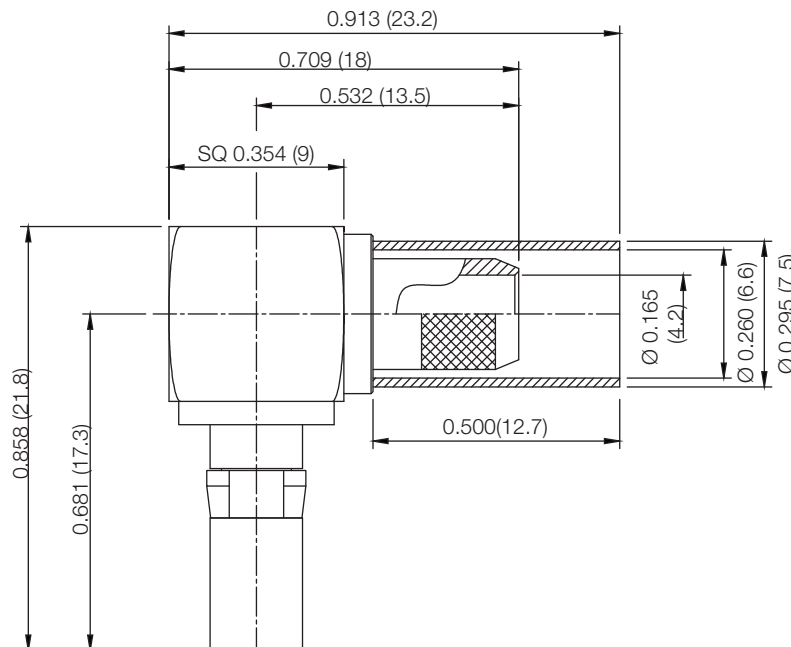
RoHS Compliant

VSWR and Frequency Range Specifications
 are for reference and are dependant on cable
 type and other application specific conditions

Drawing not to scale. Dimensions for reference only

Units: inches (mm)

WWW.KONNECTRF.COM
 1-800-790-5887

PART NUMBER

KCC197204

DESCRIPTION

1.0/2.3 DIN, E-Type, Right Angle Male Plug, Crimp

CAGE CODE

664U0

SIGNATURE

X

THIS DRAWING INCLUDING THE
 DESIGNS IS THE PROPERTY OF
 KONNECT RF AND IS NOT TO
 BE USED FOR ANY PURPOSE
 WITHOUT OUR APPROVAL.

Cable Types: LMR-240**Component****Material****Plating**

Body

Brass

Gold

Center Contact

Brass

Gold

Snap ring

BeCu

Nickel

Insulator

PTFE

Ferrule

Brass

Nickel