

PART NUMBER

KCC197181

REV.

DATE

COMMENTS

INITIAL

Electrical Data

Impedance 50 Ω
 Frequency Range DC - 12.4 GHz.
 Working Voltage 250 VRMS max
 Insulation Resistance 1,000M Ω min
 Dielectric Withstanding Voltage 750V min
 VSWR 1.15 + 0.03xF(GHz)

Mechanical Data

Temperature Range: -55 °C - 145 °C

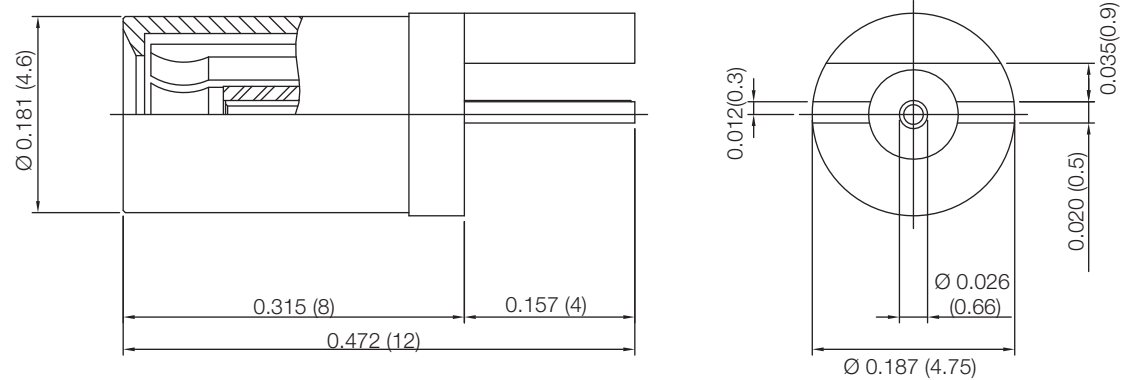
RoHS Compliant

Drawing not to scale. Dimensions for reference only

Units: inches (mm)

Konnect RF

WWW.KONNECTRF.COM
 1-800-790-5887

PART NUMBER

KCC197181

DESCRIPTION

**SSMB Straight Male Jack Mount PC Board Receptacle,
Edge Mount , Plug PCB (0.31 board)**

CAGE CODE

664U0

SIGNATURE

X

THIS DRAWING INCLUDING THE
 DESIGNS IS THE PROPERTY OF
 KONNECT RF AND IS NOT TO
 BE USED FOR ANY PURPOSE
 WITHOUT OUR APPROVAL.

Component

Cover
 Outer Contact
 Center Contact
 Insulator

Material

Brass
 BeCu
 BeCu
 PTFE

Plating

Gold
 Gold
 Gold