

PART NUMBER

KCC197131

REV.

DATE

COMMENTS

INITIAL

Electrical Data

Impedance 50 Ω
 Frequency Range DC - 12.4GHz.

Mechanical Data

Durability 500 Cycles Min.
 Temperature Range: -65 °C - 165 °C

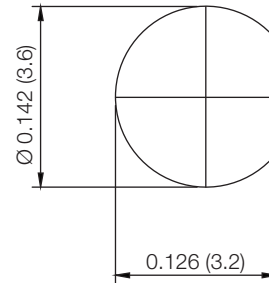
RoHS Compliant

Panel Mounting

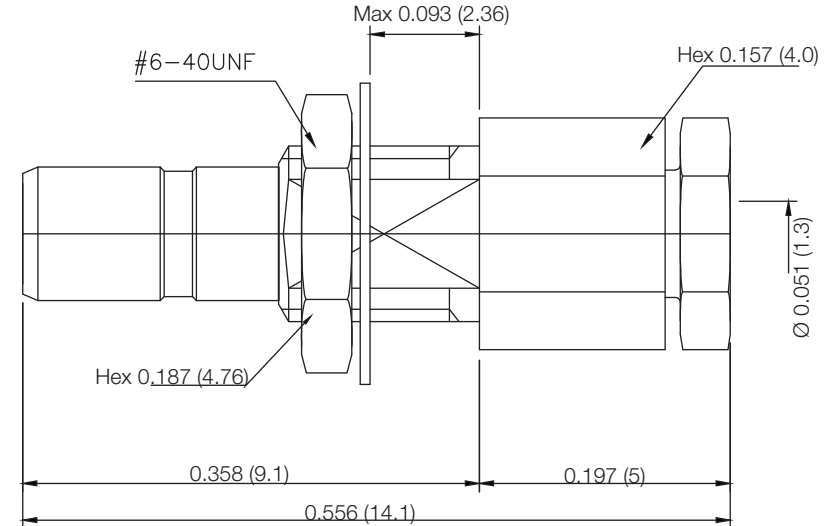

VSWR and Frequency Range Specifications
 are for reference and are dependant on cable
 type and other application specific conditions

Drawing not to scale. Dimensions for reference only

Units: inches (mm)

Konnect RF

WWW.KONNECTRF.COM
 1-800-790-5887

PART NUMBER

KCC197131

DESCRIPTION

SSMB Straight Male Jack, Bulkhead Panel Mount, Clamp, Captivated Contact

CAGE CODE

664U0

SIGNATURE

X

THIS DRAWING INCLUDING THE
 DESIGNS IS THE PROPERTY OF
 KONNECT RF AND IS NOT TO
 BE USED FOR ANY PURPOSE
 WITHOUT OUR APPROVAL.

Cable Types: UT047**Component**

Body, Nut & Washer
 Clamp Nut
 Center Contact
 Insulator

Material

Brass
 Brass
 Brass
 PTFE

Plating

Gold
 Gold
 Gold