

PART NUMBER

KCC197074

REV.

DATE

COMMENTS

INITIAL

RoHS Compliant

Electrical Data

Impedance	50 Ω
Frequency Range	DC - 6GHz.
Insertion Loss	0.05 \sqrt{F} (GHz)
Working Voltage	335 VRMS max
Insulation Resistance	5,000M Ω min
Dielectric Withstanding Voltage	750V min
VSWR	1.15+0.1 $\times F$ (GHz)

Mechanical Data

Temperature Range: -55 °C - 145 °C

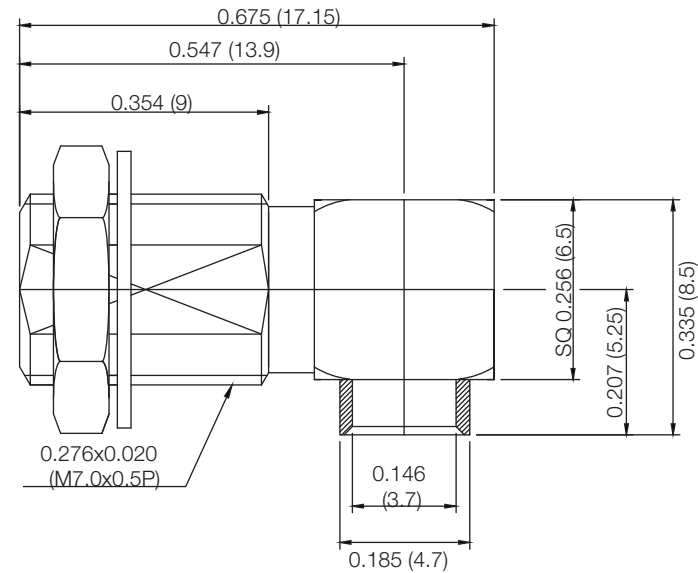
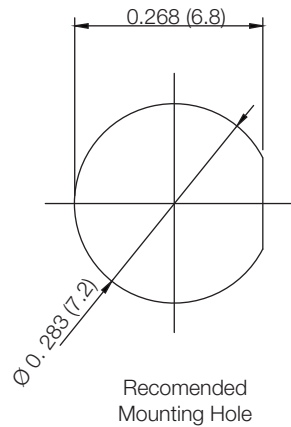

Drawing not to scale. Dimensions for reference only

Units: inches (mm)

Konnect RF

WWW.KONNECTRF.COM
1-800-790-5887

PART NUMBER

KCC197074

DESCRIPTION

BMA Female Right Angle Bulkhead Plug

CAGE CODE

664U0

SIGNATURE

X

THIS DRAWING INCLUDING THE DESIGNS IS THE PROPERTY OF KONNECT RF AND IS NOT TO BE USED FOR ANY PURPOSE WITHOUT OUR APPROVAL.

Cable Types: .141 (RG-402)

Component	Material	Plating
Body & Nut	Brass	Gold
Center Contact	Brass	Gold
Insulator	PTFE	
Washer	Stainless Steel	Gold