

PART NUMBER

**KCC197002**

REV.

DATE

COMMENTS

INITIAL

**Electrical Data**

Impedance 50  $\Omega$   
 Frequency Range DC - 6GHz.  
 Insertion Loss  $\leq$  XX dB  
 Working Voltage 1,000 VRMS  
 VSWR MAX 1.20 @ 6.0GHz

**Mechanical Data**

Temperature Range: -45 °C - 125 °C

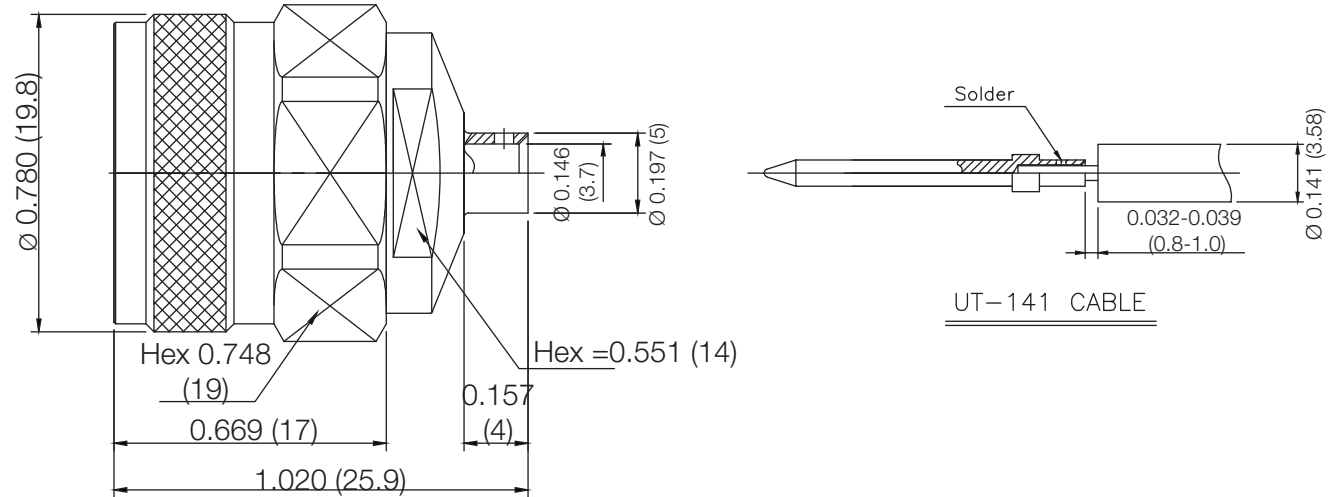
**RoHS Compliant**

Drawing not to scale. Dimensions for reference only

Units: inches (mm)

**Konnnect RF**

WWW.KONNECTRF.COM  
 1-800-790-5887

PART NUMBER

**KCC197002**

CAGE CODE

**664U0**

SIGNATURE

X

THIS DRAWING INCLUDING THE  
 DESIGNS IS THE PROPERTY OF  
 KONNECT RF AND IS NOT TO  
 BE USED FOR ANY PURPOSE  
 WITHOUT OUR APPROVAL.

DESCRIPTION

**N Straight Male Plug, Silver/Brass, Solder****Cable Types:** .141 S/R (RG-402)**Component**

Body  
 Center Contact  
 Insulator  
 Seal

**Material**

Brass  
 Brass  
 PTFE  
 Silicone Rubber

**Plating**

Silver  
 Gold