

PART NUMBER

KCC189953

REV.

DATE

COMMENTS

INITIAL

RoHS Compliant**Electrical Data**

Impedance	50 Ω
Frequency Range	DC - 3 GHz.
VSWR	1.25 @ 3 GHz max
Intermodulation	(2x20w)-160dBc

0.787 x 0.039
(M20x1.0P)

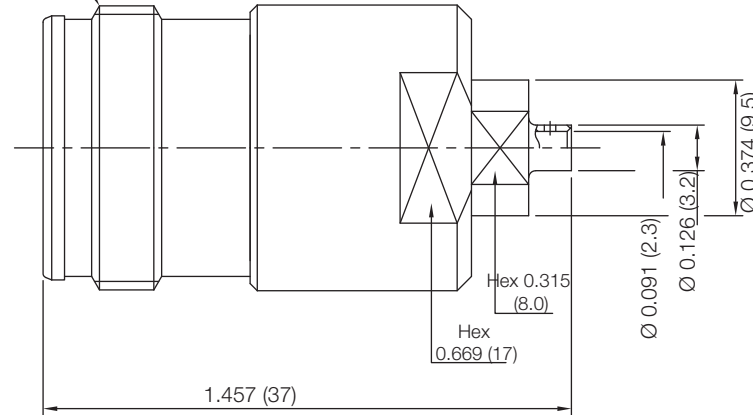

VSWR and Frequency Range Specifications are for reference and are dependant on cable type and other application specific conditions

Drawing not to scale. Dimensions for reference only

Units: inches (mm)

WWW.KONNECTRF.COM
1-800-790-5887

PART NUMBER

KCC189953

DESCRIPTION

4.3-10 Straight Female Jack, Solder

CAGE CODE

664U0

SIGNATURE

X

Cable Types: .085 SEMIRIGID / RG405**Component**

Body & Clamp Nut
Center Contact
Insulator

Material

Brass
BeCu
PTFE

Plating

White Bronze
Silver

THIS DRAWING INCLUDING THE DESIGNS IS THE PROPERTY OF KONNECT RF AND IS NOT TO BE USED FOR ANY PURPOSE WITHOUT OUR APPROVAL.