

PART NUMBER

**KCC189840**

REV.

DATE

COMMENTS

INITIAL

**Electrical Data**

Impedance 50  $\Omega$   
 Frequency Range DC - 26.5 GHz.  
 Voltage Rating 500 Max  
 Insulation Resistance 5,000 M $\Omega$   
 Dielectric Withstanding Voltage 750 VRMS  
 VSWR 1.25 Max @ 18 GHz

**RoHS Compliant****Mechanical Data**

Temperature Range: -45 °C - 125 °C

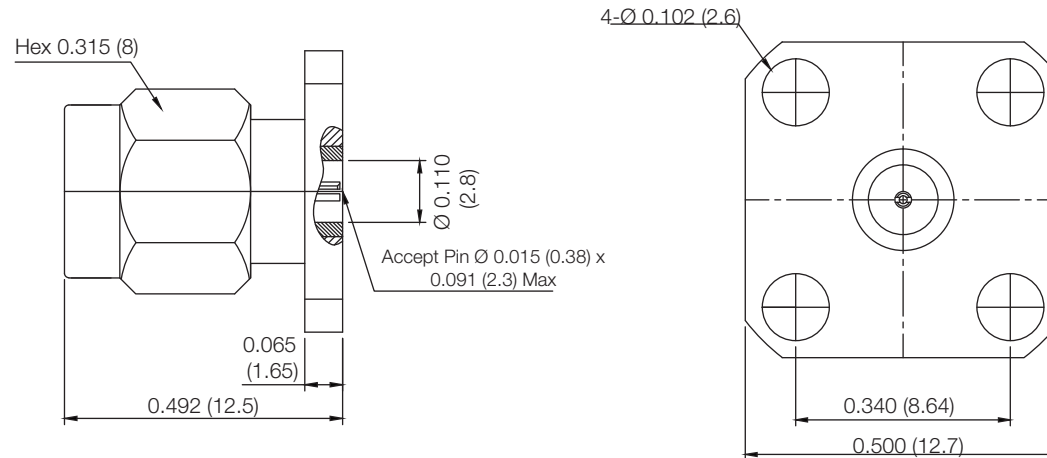

Drawing not to scale. Dimensions for reference only

Units: inches (mm)

**Konnect RF**

WWW.KONNECTRF.COM  
 1-800-790-5887

PART NUMBER

**KCC189840**

DESCRIPTION

**SMA Straight Male Plug Field Replaceable Receptacle, 4 Hole Flange Mount, Air Dielectric**

CAGE CODE

**664U0**

SIGNATURE

X

THIS DRAWING INCLUDING THE DESIGNS IS THE PROPERTY OF KONNECT RF AND IS NOT TO BE USED FOR ANY PURPOSE WITHOUT OUR APPROVAL.

**Component**

Body & Coupling Cap  
 Center Contact  
 Insulator

**Material**

Stainless Steel  
 Becu  
 PTFE

**Plating/Finish**

Passivated  
 Gold