

PART NUMBER

KCC189766

REV.

DATE

COMMENTS

INITIAL

Electrical Data

RoHS Compliant

Impedance

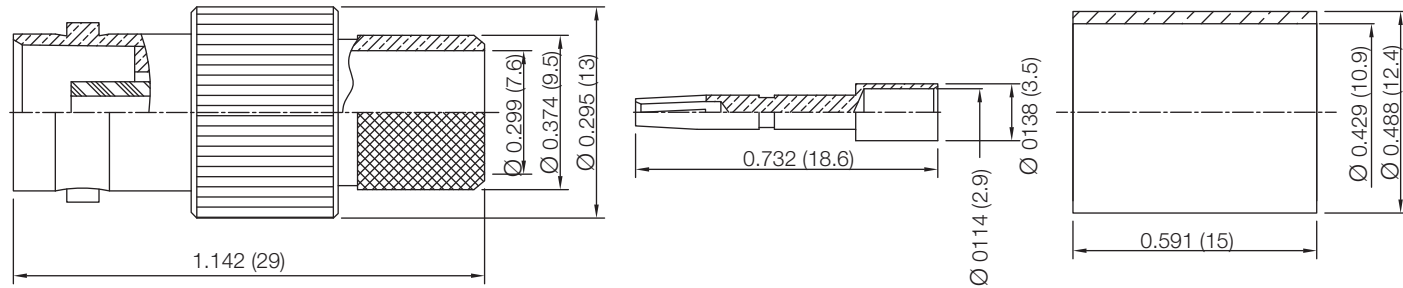
50 Ω 

NOTES: FINISH (PLATING THICKNESS IN MICRO-INCHES)

Drawing not to scale. Dimensions for reference only

Units: inches (mm)

Konnect RFWWW.KONNECTRF.COM
1-800-790-5887

PART NUMBER

KCC189766

DESCRIPTION

BNC Straight Female Jack, Crimp

CAGE CODE

664U0

SIGNATURE

X

THIS DRAWING INCLUDING THE
DESIGNS IS THE PROPERTY OF
KONNECT RF AND IS NOT TO
BE USED FOR ANY PURPOSE
WITHOUT OUR APPROVAL.**Cable Types: RG-213 & LMR-400****Component**Body & Ferrule
Center Contact
Lock Ring
Insulator**Material**Brass
Phos. Bronze
Brass
PTFE**Plating**Nickel
Gold
Nickel