

PART NUMBER

**KCC189763**

REV.

DATE

COMMENTS

INITIAL

**Electrical Data**

Impedance 50Ω  
 Frequency Range DC - 40 GHz.  
 Insulation Resistance 5,000 MΩ  
 Dielectric Withstanding Voltage 1,000 VRMS  
 VSWR 1.15 Max

RoHS Compliant

**Mechanical Data**

Durability 500 Cycles Min.  
 Temperature Range: -65 °C - 165 °C

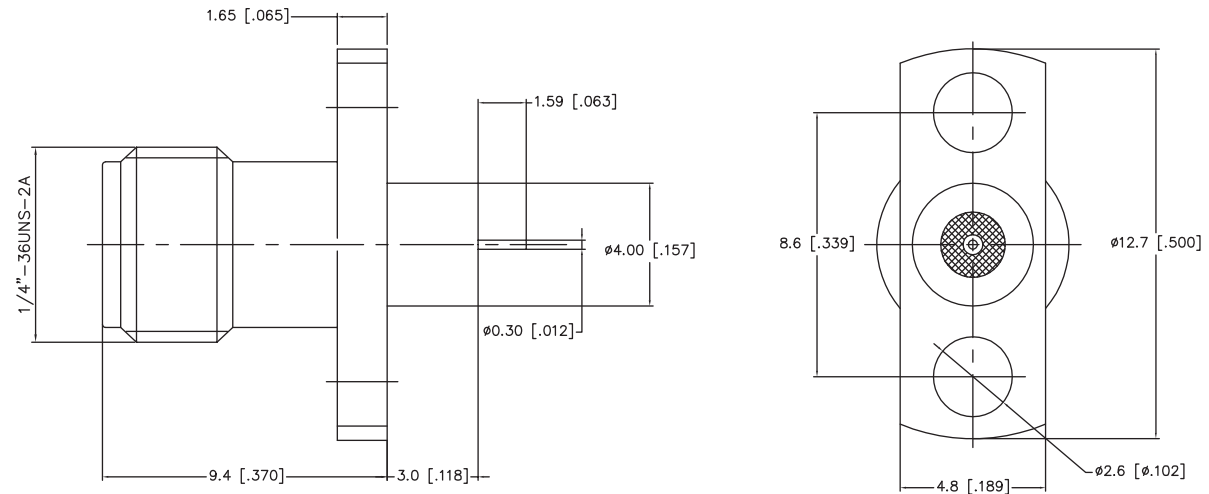

Drawing not to scale. Dimensions for reference only

Units: mm (inches)

**Konnect RF**

WWW.KONNECTRF.COM  
 1-800-790-5887

PART NUMBER

**KCC189763**

DESCRIPTION

**2.92mm Straight Female Jack Receptacle,  
 2 Hole Flange Mount, Extended Teflon**

CAGE CODE

**664U0**

SIGNATURE

X

THIS DRAWING INCLUDING THE  
 DESIGNS IS THE PROPERTY OF  
 KONNECT RF AND IS NOT TO  
 BE USED FOR ANY PURPOSE  
 WITHOUT OUR APPROVAL.

**Component**

Body  
 Center Contact  
 Insulator

**Material**

Stainless Steel  
 BeCu  
 PEI

**Plating/Finish**

Passivated  
 Gold