

PART NUMBER

KCC189627

REV.

DATE

COMMENTS

INITIAL

Electrical Data

Impedance	50 Ω
Frequency Range	DC - 4 GHz.
Insulation Resistance	5,000 M Ω Min
VSWR	1.25 Max @ 2.2 GHz

RoHS Compliant

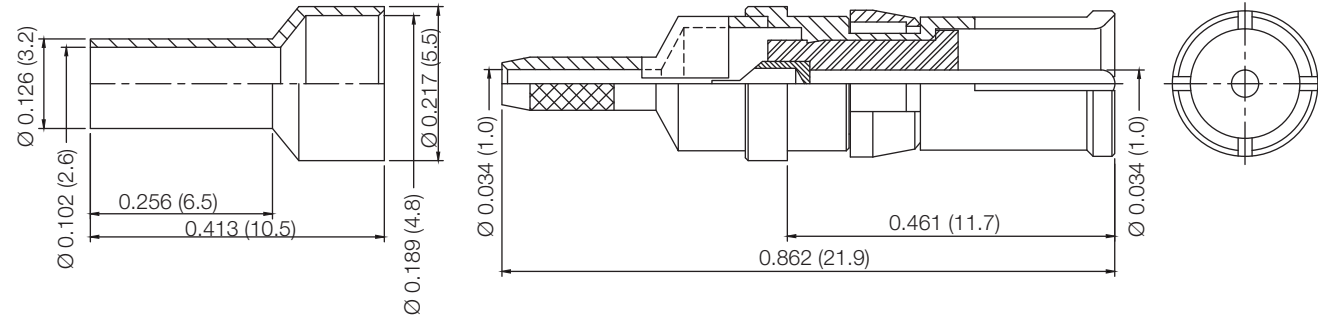

VSWR and Frequency Range Specifications
are for reference and are dependant on cable
type and other application specific conditions

Drawing not to scale. Dimensions for reference only

Units: inches (mm)

Konnect RF

WWW.KONNECTRF.COM
1-800-790-5887

PART NUMBER

KCC189627

DESCRIPTION

D-Sub Straight Male Plug, Crimp

CAGE CODE

664U0

SIGNATURE

X

THIS DRAWING INCLUDING THE
DESIGNS IS THE PROPERTY OF
KONNECT RF AND IS NOT TO
BE USED FOR ANY PURPOSE
WITHOUT OUR APPROVAL.

Cable Type: RG-178**Component**

Body
Retaining Ring
Center Contact
Insulator

Material

BeCu
BeCu
Brass
PTFE

Plating

Gold
Nickel
Gold