

PART NUMBER

KCC189422

REV.

DATE

COMMENTS

INITIAL

Electrical Data

Impedance	50 Ω
Frequency Range	DC - 12.4 GHz.
Contact Resistance	
Center	$\leq 3 \text{ m}\Omega$
Outer	$\leq 2.5 \text{ m}\Omega$
Insulation Resistance	$\geq 5000 \text{ M}\Omega$
Dielectric Withstanding Voltage	$\geq 1000 \text{ VRMS}$, 50 Hz, at sea level $\leq 335 \text{ VRMS}$, 50 Hz, at sea level
VSWR	≤ 1.20 @ DC - 3 GHz ≤ 1.30 @ 3-6 GHz

Mechanical Data

Durability	500 Cycles
Temperature Range:	-45 $^{\circ}\text{C}$ - 85 $^{\circ}\text{C}$
RoHS	Compliant

RoHS Compliant

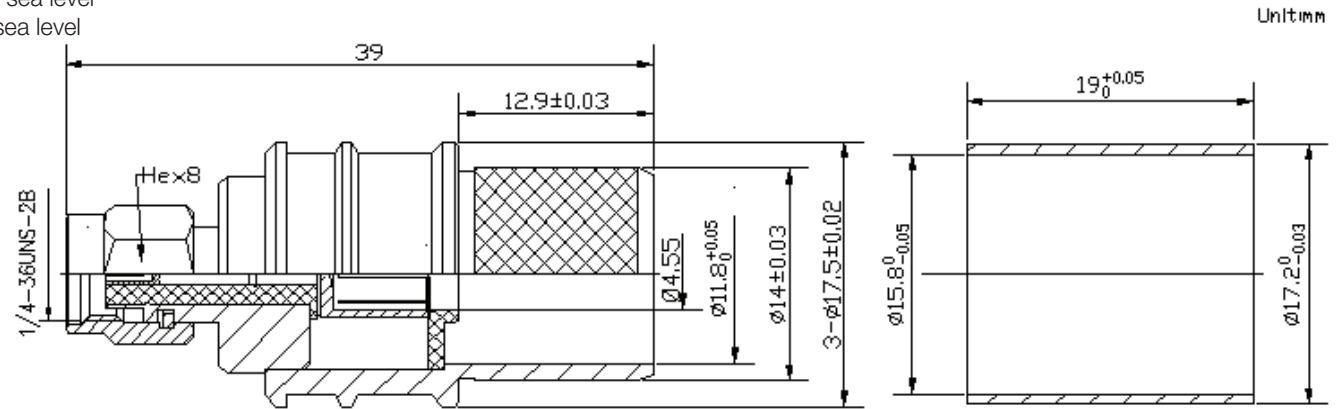

VSWR and Frequency Range Specifications are for reference and are dependant on cable type and other application specific conditions

Drawing not to scale. Dimensions for reference only Units: mm

WWW.KONNECTRF.COM
1-800-790-5887

PART NUMBER

KCC189422

DESCRIPTION

SMA Straight Male Plug Reverse Polarity, Crimp Nickel/Brass

CAGE CODE

664U0

SIGNATURE

X

Cable: LMR-600

Component
Body & Nut
Center Contact
Insulator
Retaining Ring
Ferrule
Gasket

Material

Brass
Phosphor Bronze
PTFE
Phosphor Bronze
Annealed Copper
Silicone Rubber

Plating

Nickel
Gold
Nickel

THIS DRAWING INCLUDING THE DESIGNS IS THE PROPERTY OF KONNECT RF AND IS NOT TO BE USED FOR ANY PURPOSE WITHOUT OUR APPROVAL.