

PART NUMBER

**KCC189390**

REV.

DATE

COMMENTS

INITIAL

**Electrical Data**

Impedance 50  $\Omega$   
 Frequency Range DC - 26.5 GHz.  
 Insulation Resistance 5,000 M $\Omega$   
 Dielectric Withstanding Voltage 750 VRMS  
 VSWR 1.10 + (0.01\*F)/F:  
 Operating Frequency in GHz

**Mechanical Data**

Temperature Range: -55 °C - 125 °C

RoHS Compliant

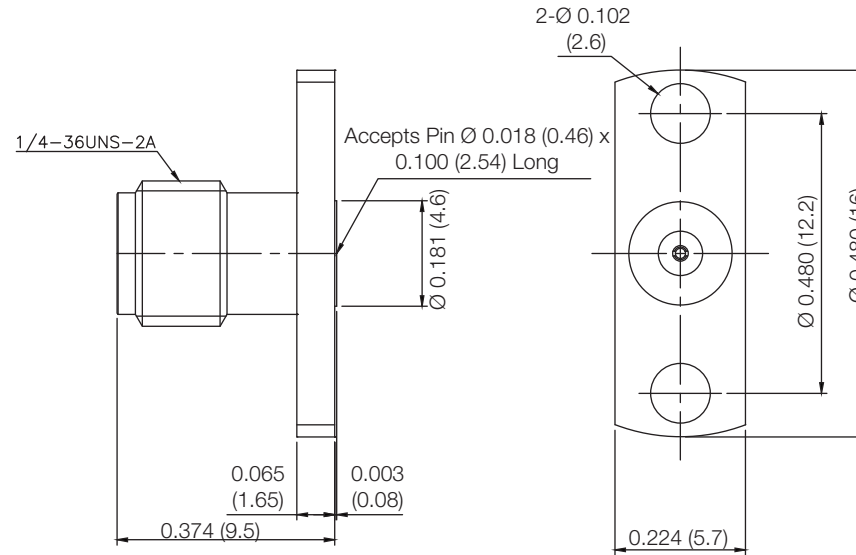

Drawing not to scale. Dimensions for reference only

Units: inches (mm)

**Konnect RF**

WWW.KONNECTRF.COM  
 1-800-790-5887

PART NUMBER

**KCC189390**

DESCRIPTION

**SMA Straight Female Jack Field Replaceable Receptacle, 2 Hole Flange Mount**

CAGE CODE

**664U0**

SIGNATURE

X

THIS DRAWING INCLUDING THE DESIGNS IS THE PROPERTY OF KONNECT RF AND IS NOT TO BE USED FOR ANY PURPOSE WITHOUT OUR APPROVAL.

**Component**

Body

**Material**Stainless Steel  
(Non-Magnetic)**Plating/Finish**

Passivated

Center Contact  
InsulatorBeCu  
PTFE

Gold 1.27