

PART NUMBER

**KCC188917**

REV.

DATE

COMMENTS

INITIAL

**Electrical Data**

Impedance	50 $\Omega$
Frequency Range	DC - 12.4 GHz.
Working Voltage	335 VRMS
Insulation Resistance	5,000 M $\Omega$
Dielectric Withstanding Voltage	1,000 VRMS

**Mechanical Data**

Durability	500 Cycles Min.
Temperature Range:	-45 °C - 155 °C

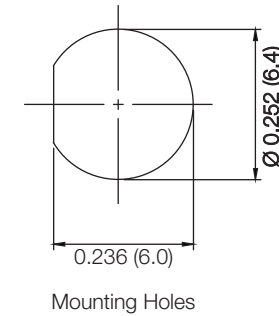
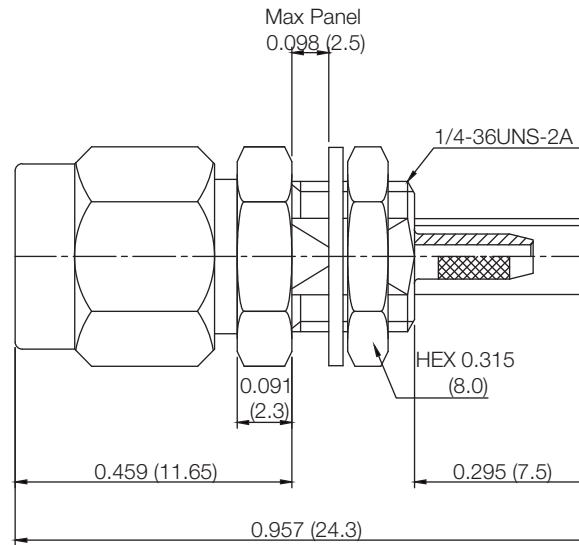
**RoHS Compliant**

Drawing not to scale. Dimensions for reference only

Units: inches (mm)

**Konnect RF**

WWW.KONNECTRF.COM  
1-800-790-5887

PART NUMBER

**KCC188917**

DESCRIPTION

**SMA Straight Male Plug, Bulkhead Front Mount, O-Ring Seal (IP67)**

CAGE CODE

**664U0**

SIGNATURE

X

**Cable Types:** RG-178

**Component**  
Body  
Center Contact  
Insulator

**Material**  
Brass  
BeCu  
PTFE

**Plating**  
Gold  
Gold

THIS DRAWING INCLUDING THE  
DESIGNS IS THE PROPERTY OF  
KONNECT RF AND IS NOT TO  
BE USED FOR ANY PURPOSE  
WITHOUT OUR APPROVAL.