

PART NUMBER

KCC188562

REV.

DATE

COMMENTS

INITIAL

Electrical Data

Impedance	50 Ω
Frequency Range	DC - 18GHz.
Insertion Loss	0.05 $\sqrt{f(\text{GHz})}$ dB
Voltage Rating	500 VRMS Max
Insulation Resistance	5,000 M Ω
Dielectric Withstanding Voltage	750 VRMS
RF Leakage	-60 dBm Min. between 2-3GHz

Mechanical Data

Temperature Range:	-45 $^{\circ}\text{C}$ - 125 $^{\circ}\text{C}$
Durability	500 Cycles

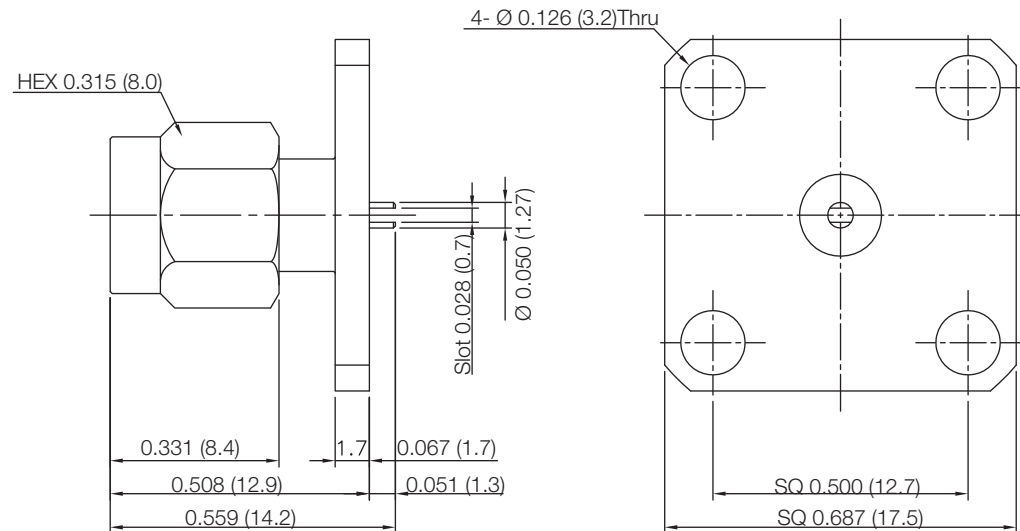
RoHS Compliant

Drawing not to scale. Dimensions for reference only

Units: inches (mm)

Konnect RF

WWW.KONNECTRF.COM
1-800-790-5887

PART NUMBER

KCC188562

DESCRIPTION

**SMA Straight Male Plug Receptacle,
4 Hole Flange Mount , Slot Terminal**

CAGE CODE

664U0

SIGNATURE

X

THIS DRAWING INCLUDING THE
DESIGNS IS THE PROPERTY OF
KONNECT RF AND IS NOT TO
BE USED FOR ANY PURPOSE
WITHOUT OUR APPROVAL.

Component

Body & Coupling Nut
Center Contact
Insulator

Material

Stainless Steel
Brass
PTFE

Plating/Finish

Passivated
Gold