

PART NUMBER

KCC188557

REV.

DATE

COMMENTS

INITIAL

Electrical Data

Impedance	50 Ω
Frequency Range	DC - 26.5 GHz.
Insertion Loss	0.03 x FGHZ dB Max
Voltage Rating	250 VRMS Max
RF Leakage	-100 dB- FGHZ
Contact Resistance	
Center	6.0 m Ω
Outer	2.0 m Ω
Insulation Resistance	10,000 M Ω
Dielectric Withstanding Voltage	750 VRMS
VSWR	1.05 + 0.006 x FGHZ max

Mechanical Data

Durability	500 Cycles Min.
Contact Captivation	
Axial Force	6.0 lbs Max
Radial torque	4.0 oz Max
Center Contact Axial Forces	
Insertion	48 ounces Min
Withdrawal	2.0 ounces Min
Connector (Dis) Engagement	2.0 IN.LBS.Max
Recommended Mating Torque	7-10 In.LBS
Temperature Range:	-65 °C - 165 °C

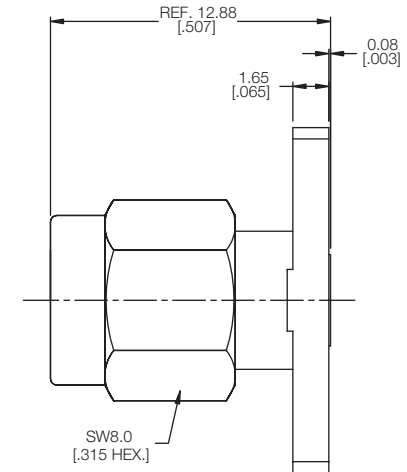
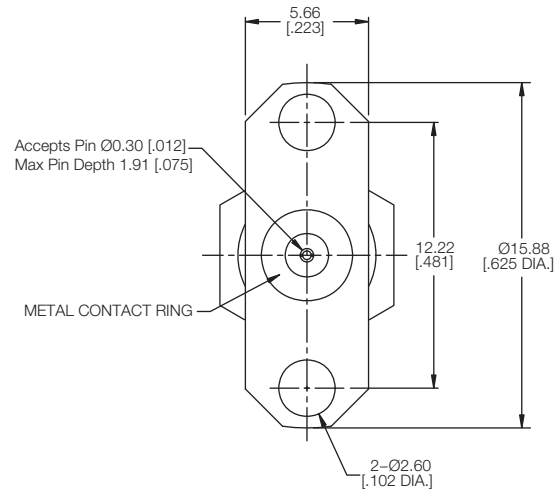
**RoHS Compliant**

Drawing not to scale. Dimensions for reference only

Units: mm (inches)

Konnect RFWWW.KONNECTRF.COM
1-800-790-5887

PART NUMBER

KCC188557

DESCRIPTION

SMA Straight Male Plug Field Replaceable Receptacle, 2 Hole Flange Mount

CAGE CODE

664U0

SIGNATURE

X

THIS DRAWING INCLUDING THE DESIGNS IS THE PROPERTY OF KONNECT RF AND IS NOT TO BE USED FOR ANY PURPOSE WITHOUT OUR APPROVAL.

ComponentBody & Coupling Nut
Center Contact
Retaining Ring
Insulator**Material**Stainless Steel
BeCu
BeCu
PTFE & PEI**Plating/Finish**Passivated
Gold
Nickel