

PART NUMBER

KCC188543

REV.

DATE

COMMENTS

INITIAL

Electrical Data

Impedance	50 Ω
Frequency Range	DC - 7.5 GHz.
Insertion Loss	≤ 0.08 dB @ 2,200 MHz
Contact Resistance	
Center	≤ 0.4 m Ω
Outer	≤ 1.0 m Ω
Dielectric Resistance	$\geq 10,000$ M Ω
Dielectric Withstanding Voltage	4,000 V RMS, 50Hz, at sea level
Working Voltage	2,700 V RMS, 50 Hz, at sea level
RF Power	3KW (max)
Intermodulation 3rd (PIM3)	≤ -155 dBc @ 2x20 W
VSWR	≤ 1.10 @ DC - 3,000 MHZ

RoHS Compliant**Mechanical Data**

Durability	≥ 500 Mating Cycles
------------	--------------------------

Environmental

Waterproof Rate	IP67
Temperature Range:	-40 $^{\circ}$ C - 85 $^{\circ}$ C

Interface

According to	IEC 60169-4 /DIN47223/CECC22190
--------------	---------------------------------

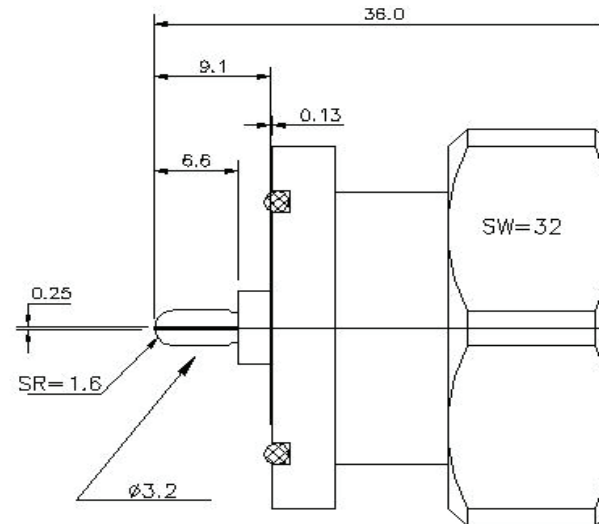

Drawing not to scale. Dimensions for reference only

Units: mm

Konnect RF

WWW.KONNECTRF.COM
1-800-790-5887

PART NUMBER

KCC188543

DESCRIPTION

7/16 DIN Straight Male Plug Receptacle, 4 Hole Flange Mount

CAGE CODE

664U0

SIGNATURE

X

THIS DRAWING INCLUDING THE
DESIGNS IS THE PROPERTY OF
KONNECT RF AND IS NOT TO
BE USED FOR ANY PURPOSE
WITHOUT OUR APPROVAL.

Component

Body & Nut
Center Conductor
Gasket

Material

Brass
Phos. Copper
Silicone Rubber

Plating

White Bronze
Silver