

PART NUMBER

KCC188183

REV.

DATE

COMMENTS

INITIAL

Electrical Data

Impedance 50 Ω
 Frequency Range DC - 18 GHz.
 Insertion Loss 0.12 $\sqrt{f(\text{GHz})}$ dB max
 VSWR 1.30 max

Mechanical Data

Durability 1,000 Cycles Min.
 Temperature Range: -65 °C - 165 °C
 Misalignment Tolerances ± 0.25 mm (Both axial and radial)

Standards

Vibration MIL-STD-202 method 204, test condition D
 Shock MIL-STD-202 method 213, test condition I
 Thermal Shock MIL-STD-202 method 207, test condition B

*Applicable MIL STD MIL-348 and DESC Specifications 94007 & 94008
 intermateable with GPO (Gilbert Engg Inc)

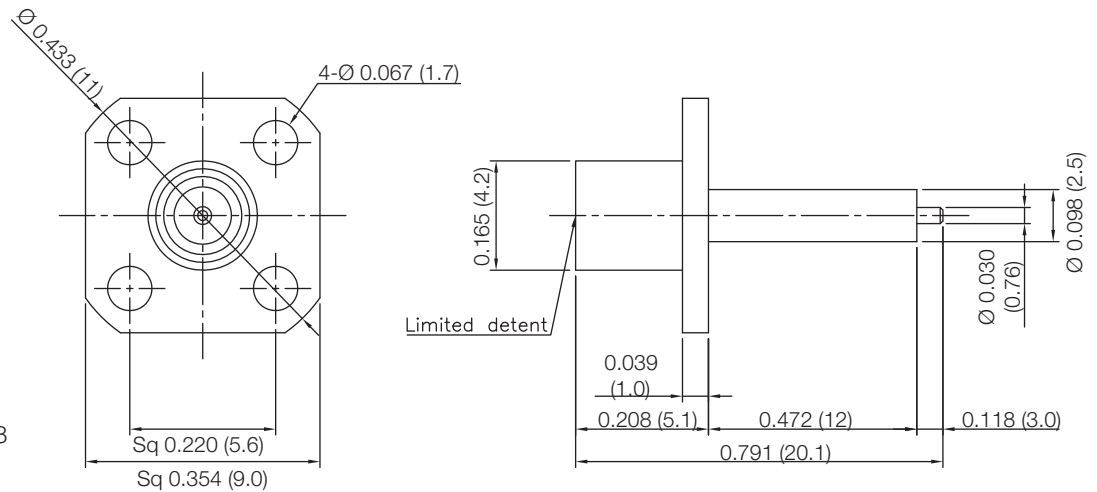
**RoHS Compliant**

Drawing not to scale. Dimensions for reference only

Units: inches (mm)

Konnect RF

WWW.KONNECTRF.COM
 1-800-790-5887

PART NUMBER

KCC188183

DESCRIPTION

**SMP Straight Male Plug (Limited Detent) Receptacle, 4
 Hole Flange Mount, Extended Teflon, Blunt Post**

CAGE CODE

664U0

SIGNATURE

X

THIS DRAWING INCLUDING THE
 DESIGNS IS THE PROPERTY OF
 KONNECT RF AND IS NOT TO
 BE USED FOR ANY PURPOSE
 WITHOUT OUR APPROVAL.

Component

Body
 Center Contact
 Insulator

Material

Brass
 BeCu
 PTFE

Plating

Gold
 Gold