

PART NUMBER

KAT177958-XX

REV.

DATE

COMMENTS

INITIAL

A

05/01/2023

Updated Attenuation Value & Accuracy Chart

*MP***Electrical Data**

Nominal Impedance : 50Ω
 Average Power : 2W average to 25°C ambient temperature, derated linearly to 0.5W @ 125°C.
 Peak Power : 0.2KW (5μs pulse width with 1% duty cycle)

RoHS Compliant**Mechanical Data**

Temperature Range: -55 °C - 125 °C

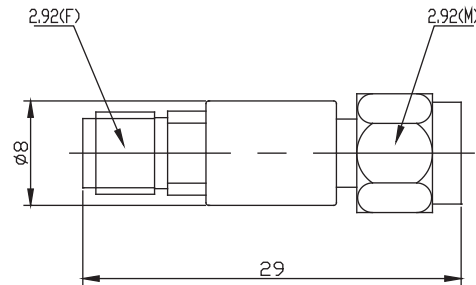

Part Number	Frequency Range(GHz)	Attenuation Value & Accuracy (dB)					Max VSWR
		1-9	10	20	30	40	
KAT177958-XX	DC-40	±1.0	±1.0	-1.0/+1.5	-1.0/+1.5	±1.5	1.35 1.40(40dB)

Drawing not to scale. Dimensions for reference only

Units: mm Tolerance ±5%

Konnect RF

WWW.KONNECTRF.COM
 1-800-790-5887

PART NUMBER

KAT177958-XX

DESCRIPTION

Fixed Attenuator, 2.92 Male/Female

CAGE CODE

664U0

SIGNATURE

X

Attenuation Value = XX

Component

Body
 Male Pin
 Female Pin
 Housing

Material

Stainless Steel
 BeCu
 BeCu
 Stainless Steel

Plating

Gold
 Gold

THIS DRAWING INCLUDING THE
 DESIGNS IS THE PROPERTY OF
 KONNECT RF AND IS NOT TO
 BE USED FOR ANY PURPOSE
 WITHOUT OUR APPROVAL.