

PART NUMBER

KAD178523

REV.

DATE

COMMENTS

INITIAL

Electrical Data

Impedance	50 Ω
Frequency Range	DC - 12.4GHz.
Working Voltage	500 VRMS max
Contact Resistance	< 3m Ω
Insulation Resistance	5,000 M Ω min
Dielectric Withstanding Voltage	1,000V min
VSWR	1.15 @ 6GHz

Mechanical Data

Durability	200 Cycles Min.
Temperature Range:	-45 °C - 145 °C

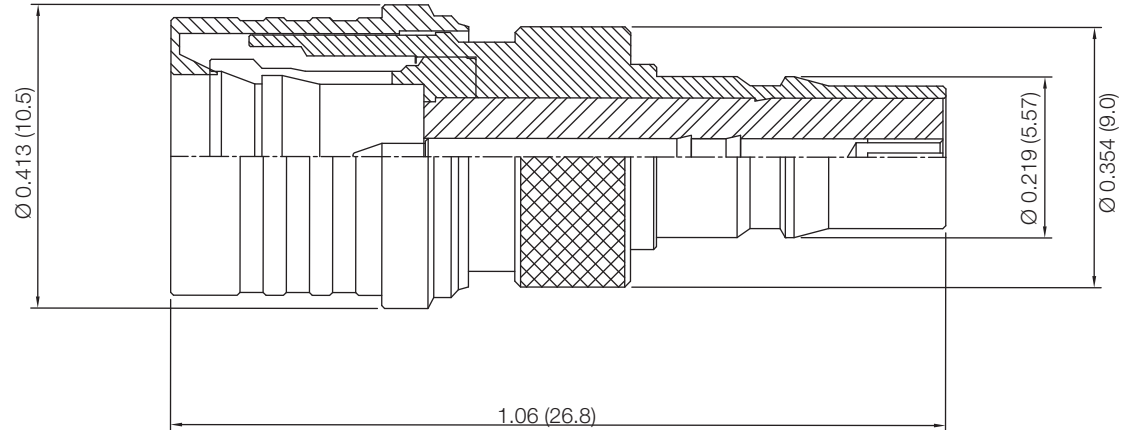
RoHS Compliant

Drawing not to scale. Dimensions for reference only

Units: inches (mm)

Konnect RF

WWW.KONNECTRF.COM
1-800-790-5887

PART NUMBER

KAD178523

DESCRIPTION

Adapter, In-Series, QMA Male Plug to Female Jack

CAGE CODE

664U0

SIGNATURE

X

THIS DRAWING INCLUDING THE DESIGNS IS THE PROPERTY OF KONNECT RF AND IS NOT TO BE USED FOR ANY PURPOSE WITHOUT OUR APPROVAL.

Component

Body & Coupling
Center Contact
Insulator

Material

Brass
BeCu
PTFE

Plating

White Bronze
Gold