

PART NUMBER

KAD178258

REV.

DATE

COMMENTS

INITIAL

Electrical Data

Impedance	50 Ω
Frequency Range	DC - 18 GHz.
Contact Resistance	3 m Ω
Working Voltage	335 VRMS max
Insulation Resistance	5,000 M Ω min
Dielectric Withstanding Voltage	1,00 V min
VSWR	1.25

Mechanical Data

Durability	500 Cycles Min.
Temperature Range:	-45 °C - 125 °C

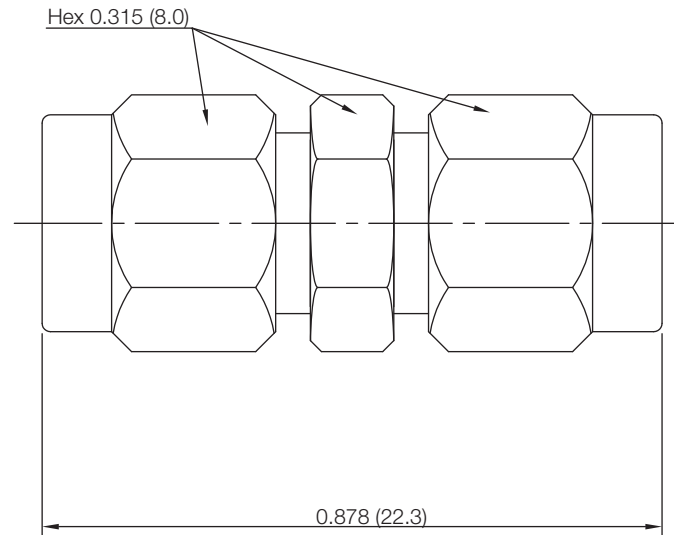
RoHS Compliant

Drawing not to scale. Dimensions for reference only

Units: inches (mm)

Konnect RF

WWW.KONNECTRF.COM
1-800-790-5887

PART NUMBER

KAD178258

DESCRIPTION

Adapter, In Series, SMA Male Plug to Male Plug

CAGE CODE

664U0

SIGNATURE

X

THIS DRAWING INCLUDING THE
DESIGNS IS THE PROPERTY OF
KONNECT RF AND IS NOT TO
BE USED FOR ANY PURPOSE
WITHOUT OUR APPROVAL.

Component

Body & Nut
Center Contact
Insulator

Material

Stainless Steel
Brass
PTFE

Plating

Gold
Gold