

PART NUMBER

KAD177557

REV.

INITIAL

Electrical Data

Impedance	50 Ω
Withstand Voltage	1000 V @ Sea Level
Working Voltage	335V
Insulation Resistance	$\geq 5000 M\Omega$
Contact Resistance	Center Contact $\leq 3 m\Omega$
	Outer Contact $\leq 2.5 m\Omega$

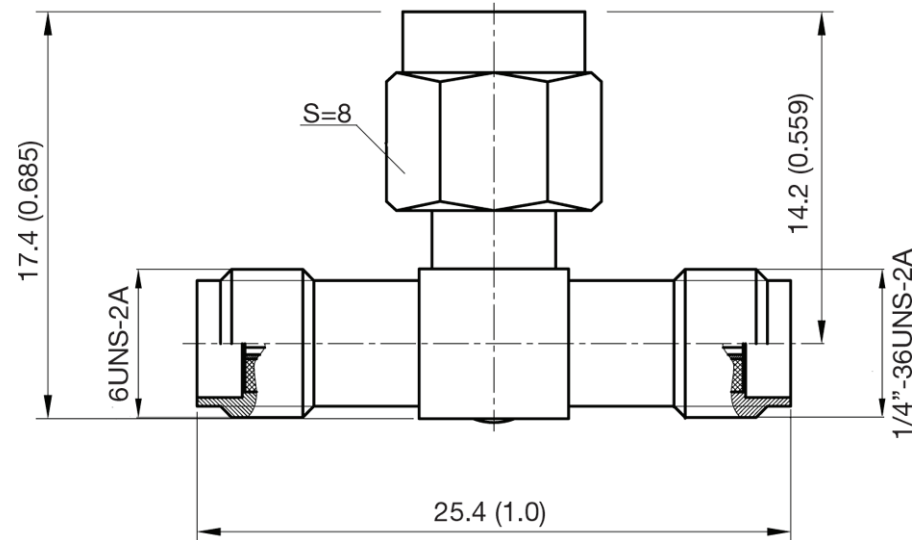
RoHS Compliant**Mechanical Data**Mating Cycles ≥ 500 Cycles**Environmental Data**Operating Temperature -55°C to $+155^{\circ}\text{C}$ **Konnnect RF**

540 NW University Blvd. Ste. 109
Port Saint Lucie, Florida, 34986
1-800-790-5887

PART NUMBER

KAD177557

DESCRIPTION

**Adapter - T Type - In-Series - SMA
Female to Male to Female**

CAGE CODE

664U0

SIGNATURE

X

THIS DRAWING INCLUDING THE
DESIGNS IS THE PROPERTY OF
KONNECT RF AND IS NOT TO
BE USED FOR ANY PURPOSE
WITHOUT OUR APPROVAL.

Materials

Body / Nut	Stainless Steel	Passivated
Center Contact (Female)	Be-Cu	Gold Plated
Center Contact (Male)	Brass	Gold Plated
Gasket	Silicone Rubber	
Insulator	PTFE	