

PART NUMBER

**KAD177430**

REV.

INITIAL

**Electrical Data**

Impedance 50  $\Omega$   
 Frequency Range DC-4 GHz  
 VSWR 1.25 Max.  
 Insertion Loss 0.25 dB Max.  
 Insulation Resistance 1000 M $\Omega$  Min.  
 Test Voltage 750 VRMS  
 Working Voltage 250 VRMS

Contact Resistance	SMC	BNC
Center Contact	5.0m $\Omega$	1.5m $\Omega$
Outer Contact	2.5m $\Omega$	1.0m $\Omega$

**Mechanical Data**

Temperature Range -55°C to 155°C  
 Mating Cycles  $\geq 500$

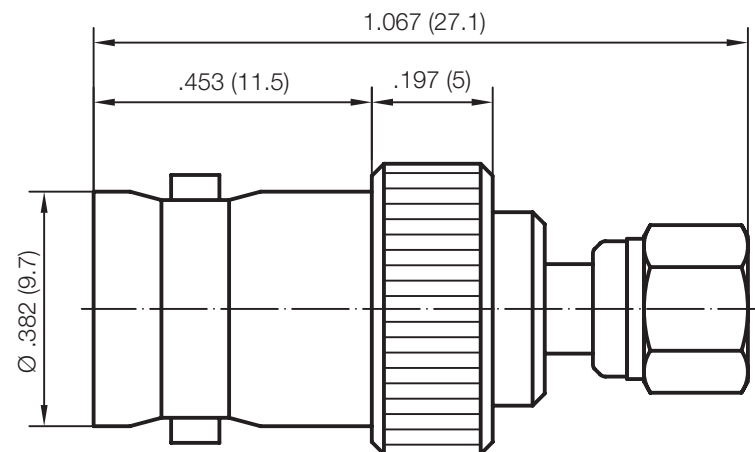
**RoHS Compliant**

Drawing not to scale. Dimensions for reference only

Units: inches (mm)

**Konnnect RF**

WWW.KONNECTRF.COM  
 1-800-790-5887

PART NUMBER

**KAD177430**

DESCRIPTION

**Adapter, Between Series**  
**BNC Female Jack to SMC Female Plug**

CAGE CODE

**664U0**

SIGNATURE

X

THIS DRAWING INCLUDING THE  
 DESIGNS IS THE PROPERTY OF  
 KONNECT RF AND IS NOT TO  
 BE USED FOR ANY PURPOSE  
 WITHOUT OUR APPROVAL.

**Component**

Body  
 Center Contact  
 Insulator

**Material**

Brass  
 Be.Cu  
 PTFE

**Plating**

Nickel  
 Gold