

PART NUMBER

KAD177200

REV.

DATE

COMMENTS

INITIAL

Electrical Data

Impedance 50 Ω
 Frequency Range DC - 11 GHz.
 VSWR ≤ 1.35

Mechanical Data

Temperature Range: -45 °C - 125 °C

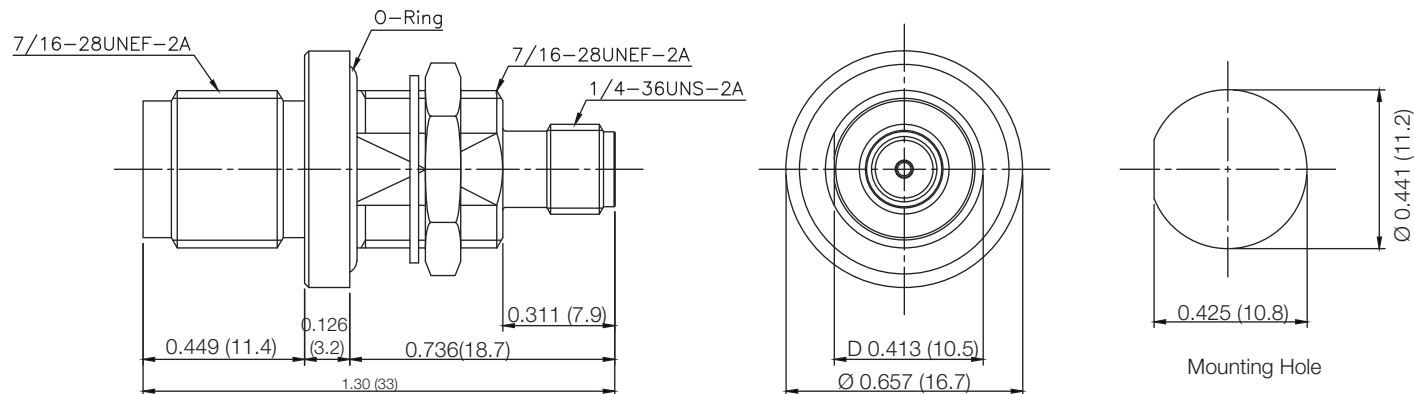
RoHS Compliant

Drawing not to scale. Dimensions for reference only

Units: inches (mm)

Konnnect RF

WWW.KONNECTRF.COM
 1-800-790-5887

PART NUMBER

KAD177200

DESCRIPTION

Adapter, Between Series, TNC Female Jack to SMA Female Jack Bulkhead

CAGE CODE

664U0

SIGNATURE

X

THIS DRAWING INCLUDING THE
 DESIGNS IS THE PROPERTY OF
 KONNECT RF AND IS NOT TO
 BE USED FOR ANY PURPOSE
 WITHOUT OUR APPROVAL.

Component

Body & Nut
 Center Contact
 Insulator
 O-Ring

Material

Brass
 BeCu
 PTFE
 Silicone Rubber

Plating

Nickel
 Gold